

XPRESS
www.rc-xpress.com

ARROWHAMIS

INSTRUCTION MANUAL

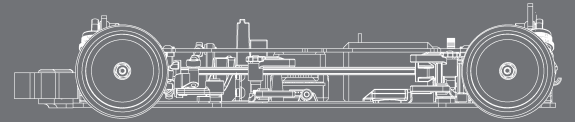

Bag A

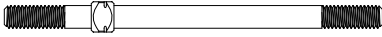

Steel Turnbuckle M3x50mm
XP-10924

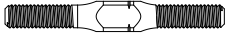

Steel Turnbuckle M3x29mm
XP-10156
Optional: XP-40089



Steel Turnbuckle M3x16mm
XP-10861

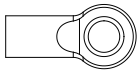

4.8mm Flat Type Ball End 13mm
XP-10682
Optional: XP-10635

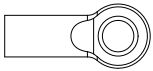

4.8mm Flat Type Ball End 15mm
XP-10251
Optional: XP-10636

For Servo

1x

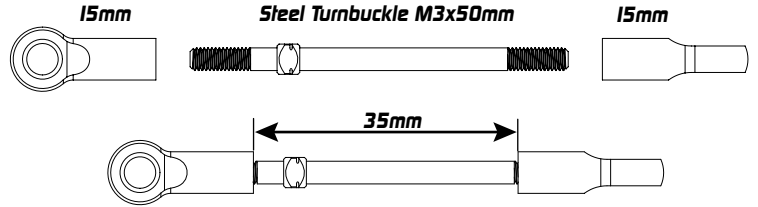

For Steering

2x

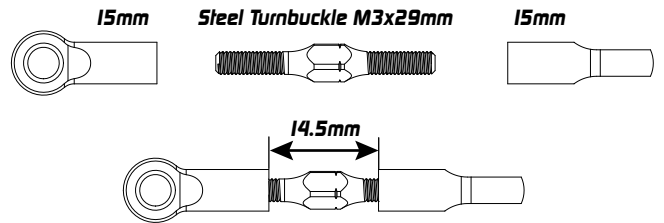

For Front Camber Link

2x

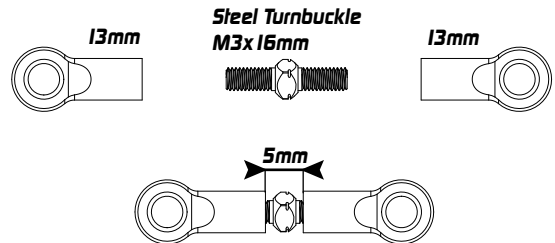

For Rear Camber Link

2x

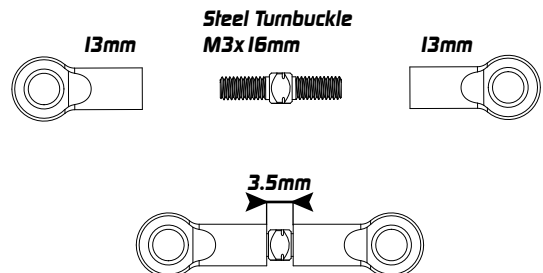

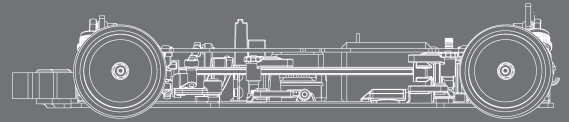

Bag B / HW / Bearing Bag

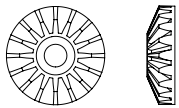

Bevel Gears (Big)
XP-10999 / XP-10996
Optional: XP-10884 + XP-10882

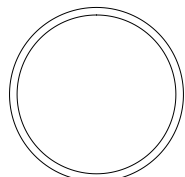

O-ring 21 x 1 mm
XP-10888 / XP-10996

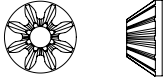

Bevel Gears (Small)
XP-10999 / XP-10996
Optional: XP-10884

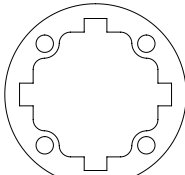

Diff Gasket
XP-10860 / XP-10996

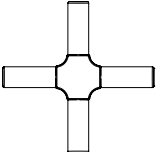

Gear Diff Cross Pin
XP-10999 / XP-10996
Optional: XP-10884

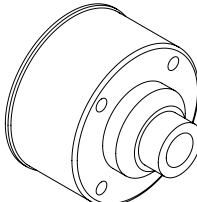

Gear Differential Case
XP-10995 / XP-10996
Optional: XP-10885

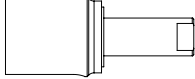

Gear Diff Outdrive Adapter (Long)
XP-10887 / XP-10996
Optional: XP-10941

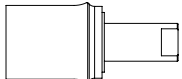

Gear Diff Outdrive Adapter (Short)
XP-10887 / XP-10996
Optional: XP-10941



Bearing 8 x 12 x 3.5mm
XP-40196



Steel Shim 5 x 13 x 0.2mm
XP-10886 / XP-10996

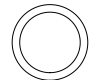

Steel Shim 8x10x0.1mm
XP-40240



Steel Shim 3x5.0x0.1mm
XP-10886 / XP-10996



O-ring 5 x 2mm
XP-10930 / XP-10996



Flat Head Screw M2.5 x 8mm
XP-10886 / XP-40044 / XP-10996

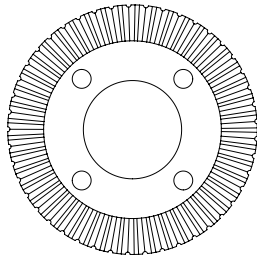

Bevel Gear Set 40T
XP-10992 / XP-10996
Optional: XP-10939

Steel Shim 5 x 13 x 0.2mm

O-ring 5 x 2mm

Diff Gasket

Gear Differential Cover

Steel Shim 8x10x0.1mm

Ball Bearing 8x12x3.5mm

Gear Differential Outdrive Adapter (Short)

Spacer 3x5.0x0.1mm

Bevel Gears (Small)

Gear Diff Cross Pin

Steel Shim 3x5.0x0.1mm

Flat Head Screw M2.5 x 8mm

Bevel Gears (Big)

Steel Shim 5x13x0.2mm

O-ring 5 x 2mm

O-ring 21 x 1 mm

Important Apply Threadlocker
Prevent damage to gears due to loose screws

Do not overtighten, ensure smooth rotation

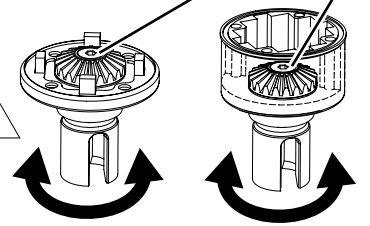

Important Apply Threadlocker
Prevent damage to gears due to loose screws

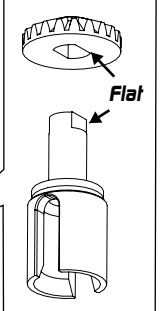

Flat Head Screw M2.5 x 8mm

Bevel Gears (Big)

Flat Head Screw M2.5 x 8mm

Track Condition
Low Grip → High Grip
1.1g Diff Oil
3000cst → 15000cst

5000cst Differential Silicone Oil

Gear Diff Outdrive Adapter (Long)

Bevel Gear Set 40T

Flat Head Screw M2.5 x 8mm

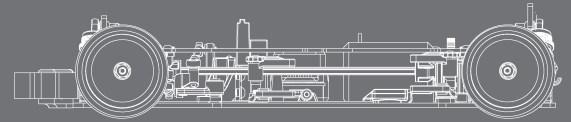

Bag C, D, G / Bearing / HW Bag

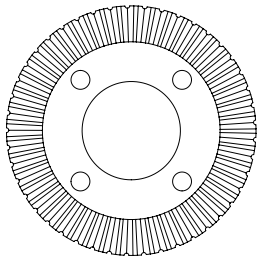

Bevel Gear Set 40T/17T
XP-10992
Optional: XP-10939

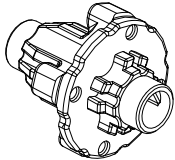
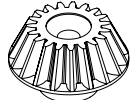

Shaft Driven Spool Set
XP-10997
Optional: XP-10847

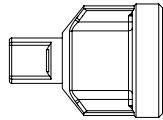

Shaft Driven Spool Set
XP-10997 / XP-10994
Optional: XP-11037
Optional: XP-10962

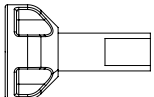

Plastic Propeller Shaft Axle & Cup
XP-11003
Optional: XP-10703

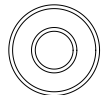

Ball Bearing 5x12x4.0mm
XP-40195



Ball Bearing 8x12x3.5mm
XP-40196



Steel Shim 8x10x0.1mm
XP-40240



Flat Head Hex Screw M2.5x8mm
XP-40044



Flat Head Hex Screw M2.5x10mm
XP-40241



Flat Head Hex Screw M2.5x15mm
XP-40200



Steel Pin 2.5x10mm
XP-40239

Shaft Driven Spool Set

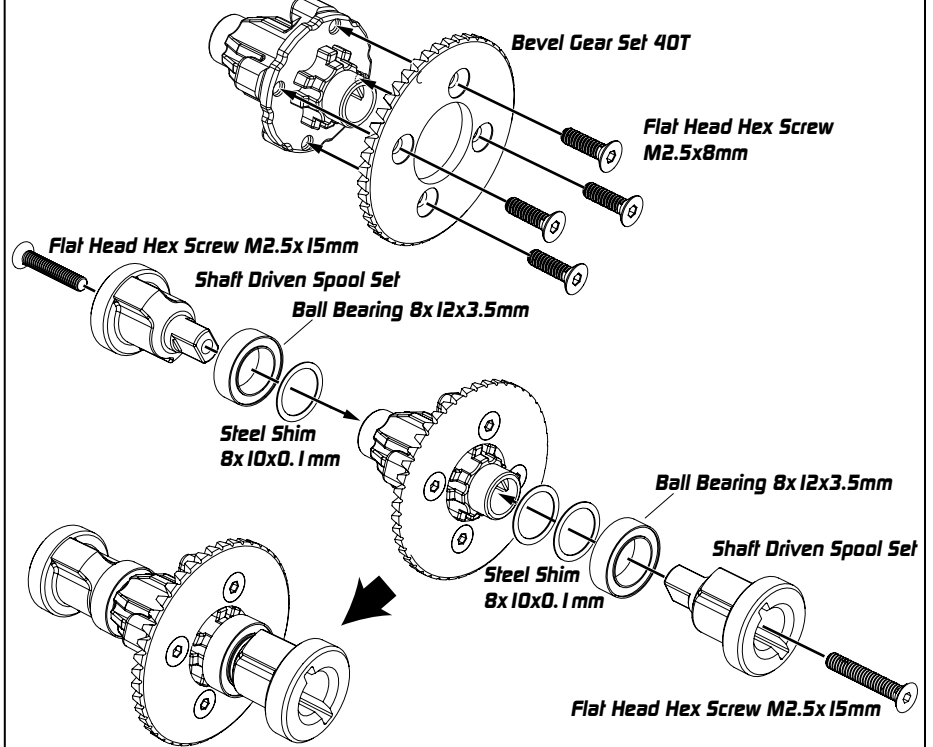

Plastic Propeller Shaft Axle

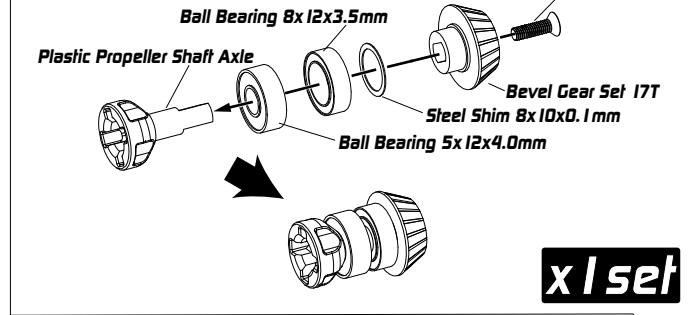

x1 set

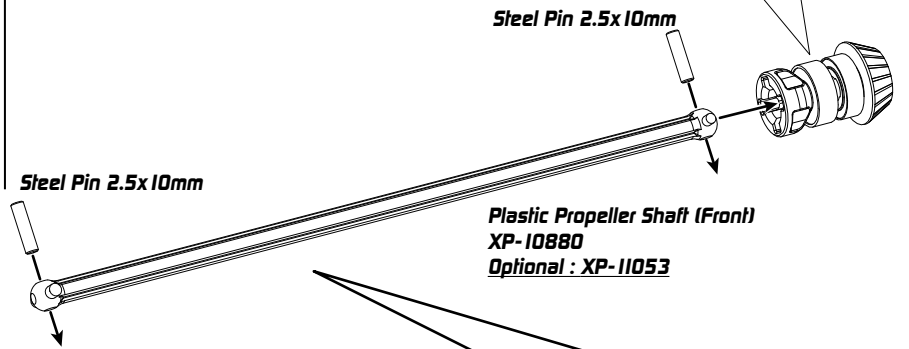

Use The Multi-tool (Bag G)

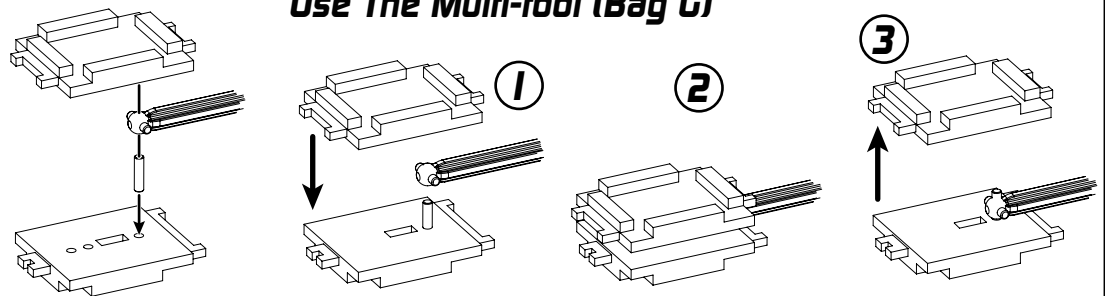

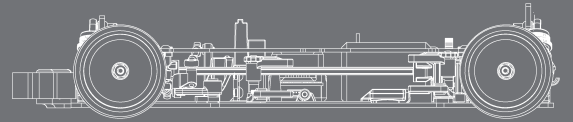

Bag E , F , Bearing / HW Bag

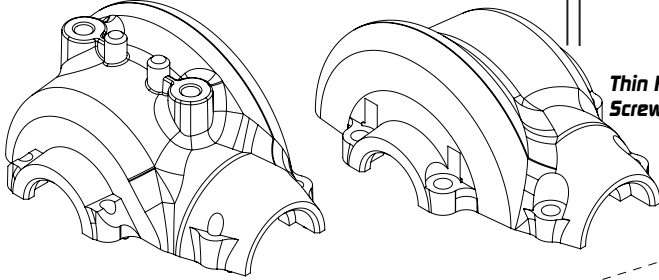

Front & Rear Gear Case
XP-10701

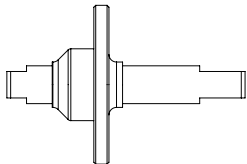
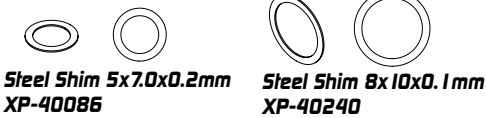

Aluminum Spur Gear Mount
XP-11040

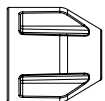

Plastic Driven Propeller Shaft Axle & Cup
XP-11003

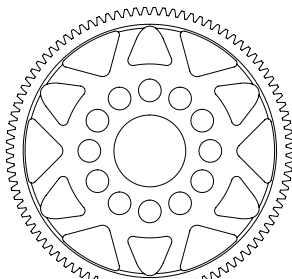

Composite Spur Gear 64P 94T
XP-40122

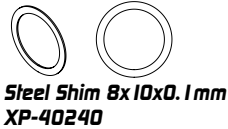

Rear Gear Box Unit

Button Head Hex Screw
M2.5x7mm

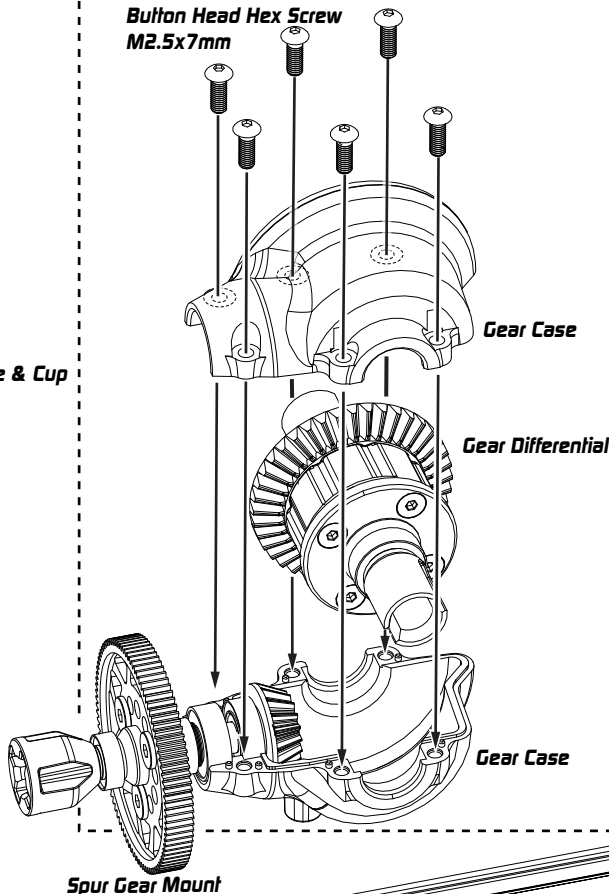

Spur Gear Mount

Composite Spur Gear
64P 94T

Thin Head Hex
Screw M3x4mm

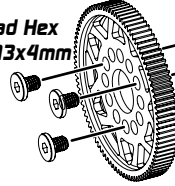

Ball Bearing
5x9x3mm

Aluminum
Spur Gear Mount

Ball Bearing
8x12x3.5mm

Flat Head Hex Screw 3x8mm

Bevel Gear
Set 17T

Steel Shim

Ball Bearing
5x12x4.0mm

Steel Shim
5x7.0x0.2mm

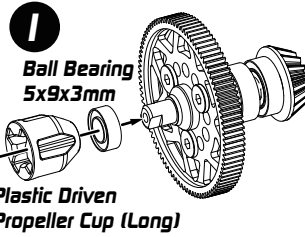

Ball Bearing
5x9x3mm

Flat Head Screw
M2.5 x 8mm

Plastic Driven
Propeller Cup (Long)

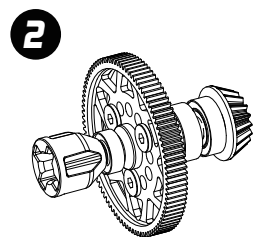

Completed Propeller Shaft

Plastic Propeller Shaft (Front)

Spur Gear Mount

Front Gear Box Unit

Button Head Hex Screw
M2.5x7mm

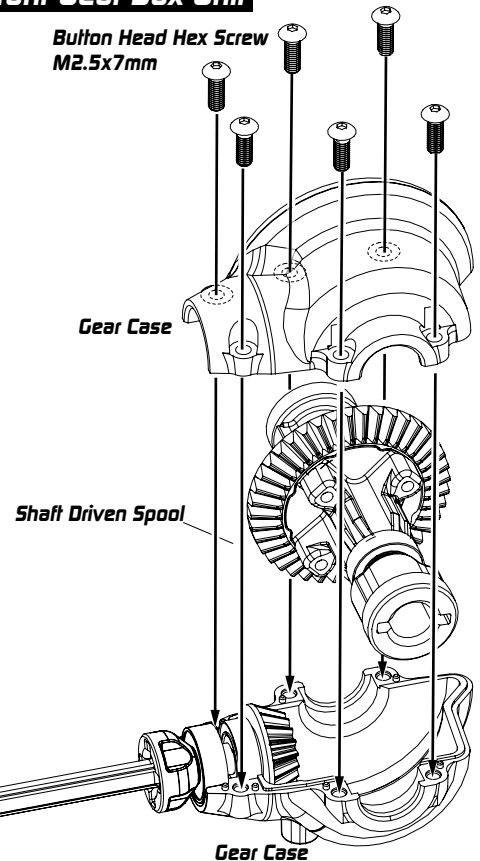

Shaft Driven Spool

Gear Case

Plastic Propeller Shaft (Front)

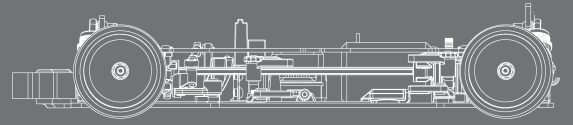

Bag H / Chassis / HW Bag

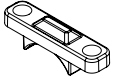

Spur Gear Mount Plate
XP-10848



Bolt Head Hex Screw M2.5x7mm
XP-40115



Flat Head Hex Screw 3x6mm
XP-40046



Flat Head Hex Screw 3x8mm
XP-40048

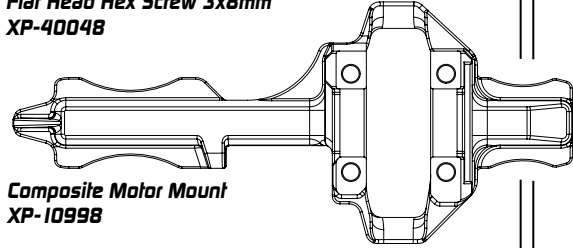

Composite Motor Mount
XP-10998



O-Ring
XP-10160

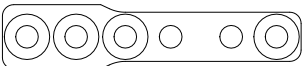
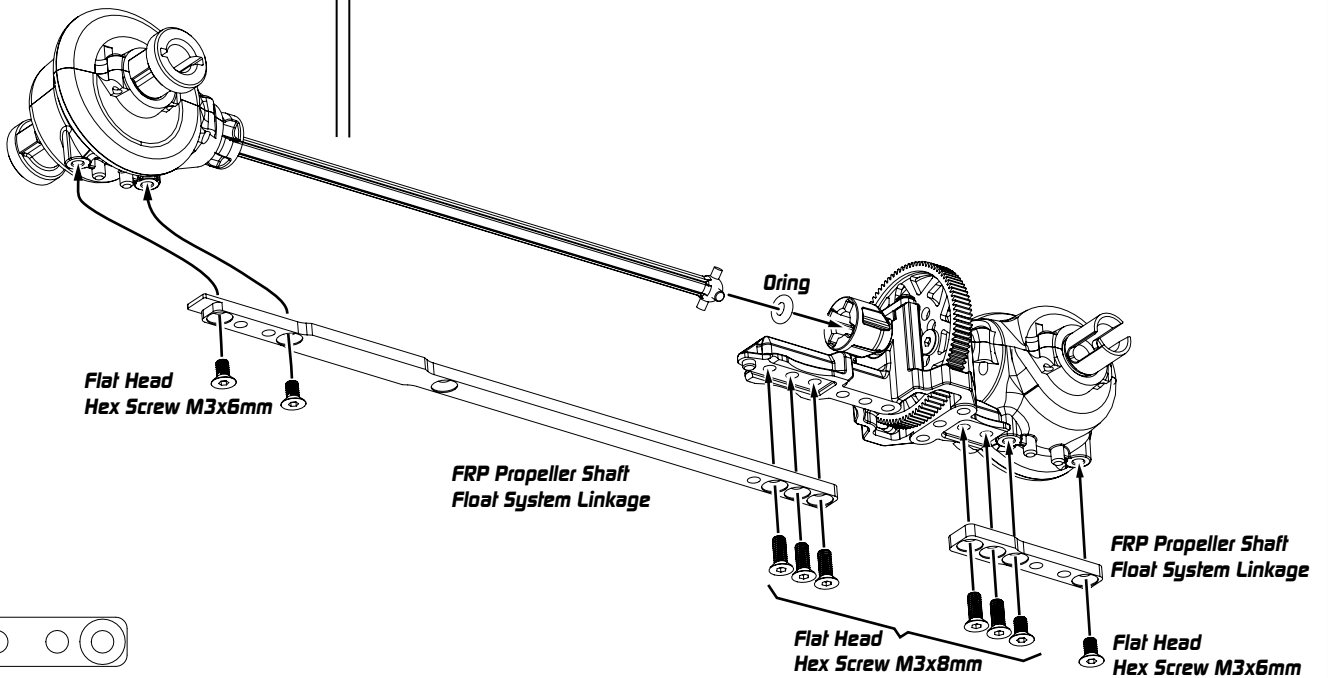
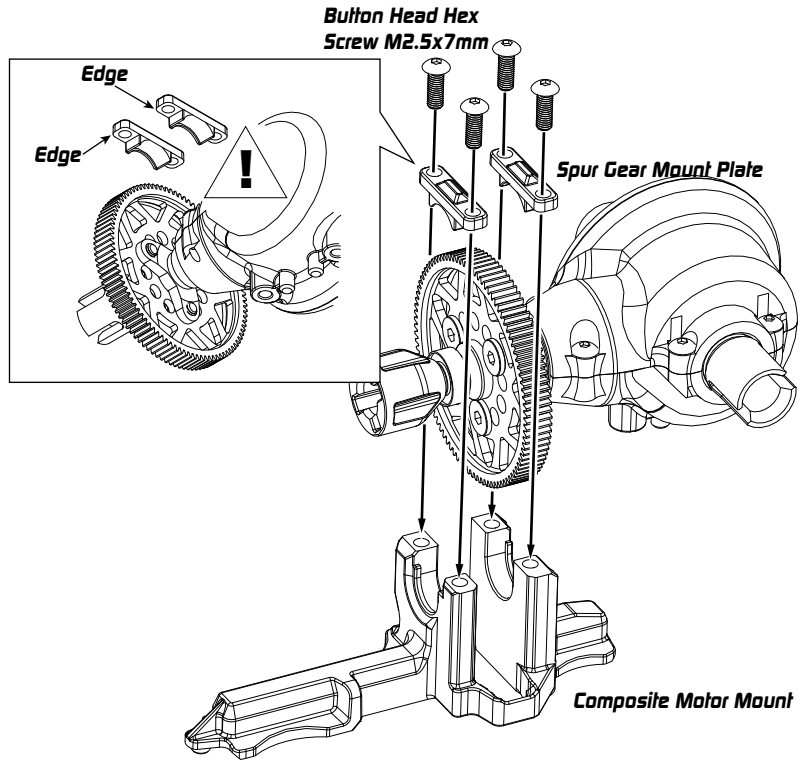

FRP Propeller Shaft Float System Linkage
XP-11039



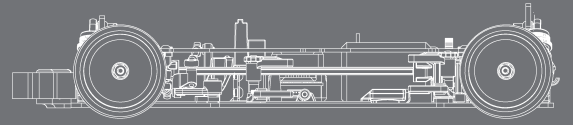

Bag G , L / HW Bag

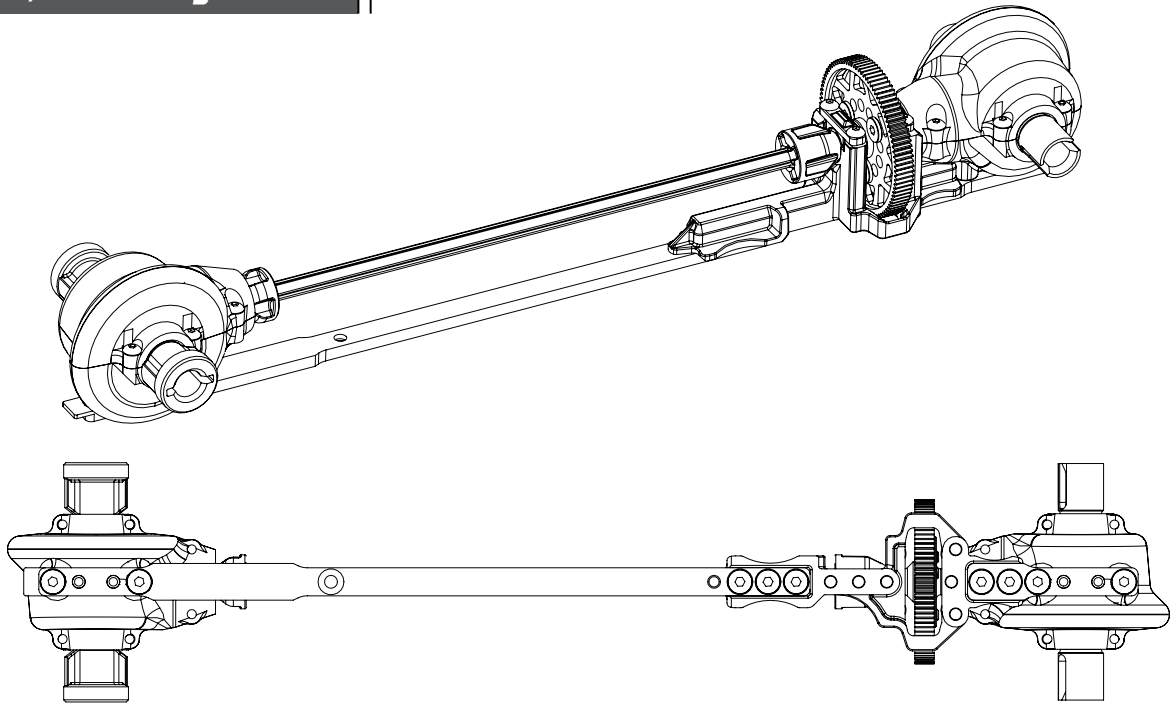

Completed Shaft Driven System

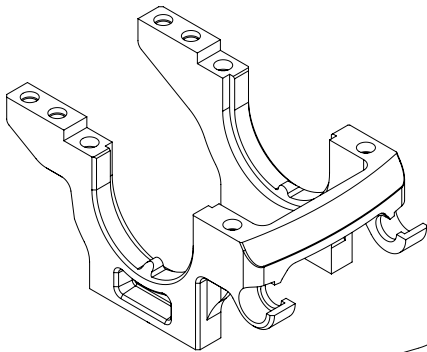

**Composite Lower Bulkhead
XP-11008**

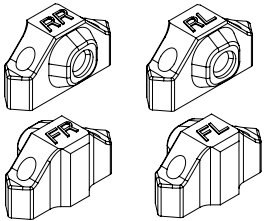

**Composite Suspension Mount Set
XP-10260**

 **Flat Head Hex Screw 3x8mm
XP-40048**

 **Flat Head Hex Screw 3x10mm
XP-40049**

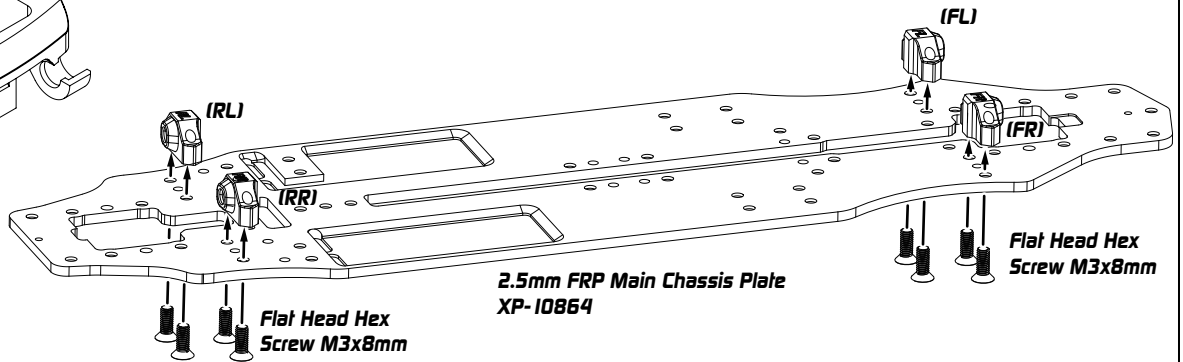

**2.5mm FRP Main Chassis Plate
XP-10864**

**Flat Head Hex
Screw M3x8mm**

**Flat Head Hex
Screw M3x8mm**

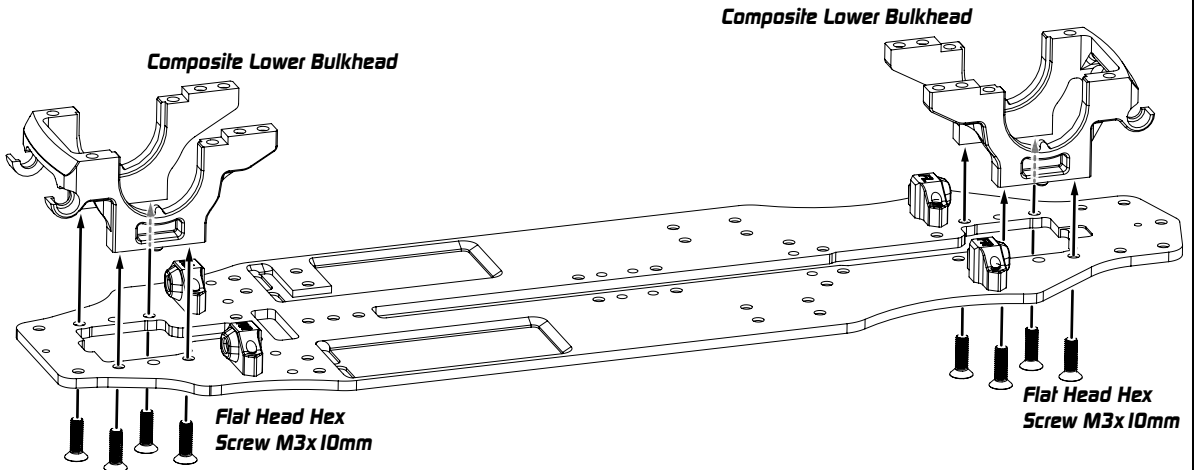

Composite Lower Bulkhead

Composite Lower Bulkhead

**Flat Head Hex
Screw M3x10mm**

**Flat Head Hex
Screw M3x10mm**

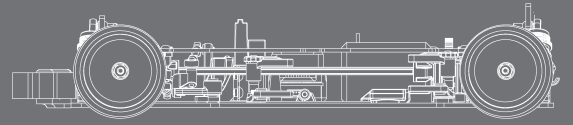

Bag H, I, O / Chassis Bag / HW Bag

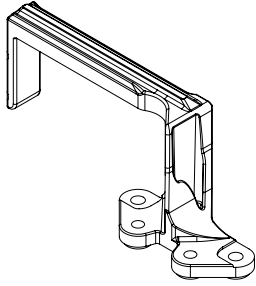

Composite Servo Mount
XP-10998



Flat Head Hex Screw M3x6mm
XP-40046



Flat Head Hex Screw M3x8mm
XP-40048



Flat Head Hex Screw M3x10mm
XP-40049



Bolt Head Hex Screw M3x8mm
XP-40038



4.8mm Ball 6mm Thread
XP-10149



Plastic Servo Spacer
XP-10848



Steel Steering Post
XP-10873
Optional: XP-10705

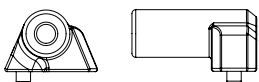

Plastic Battery Stopper
XP-10848
Optional: XP-10709

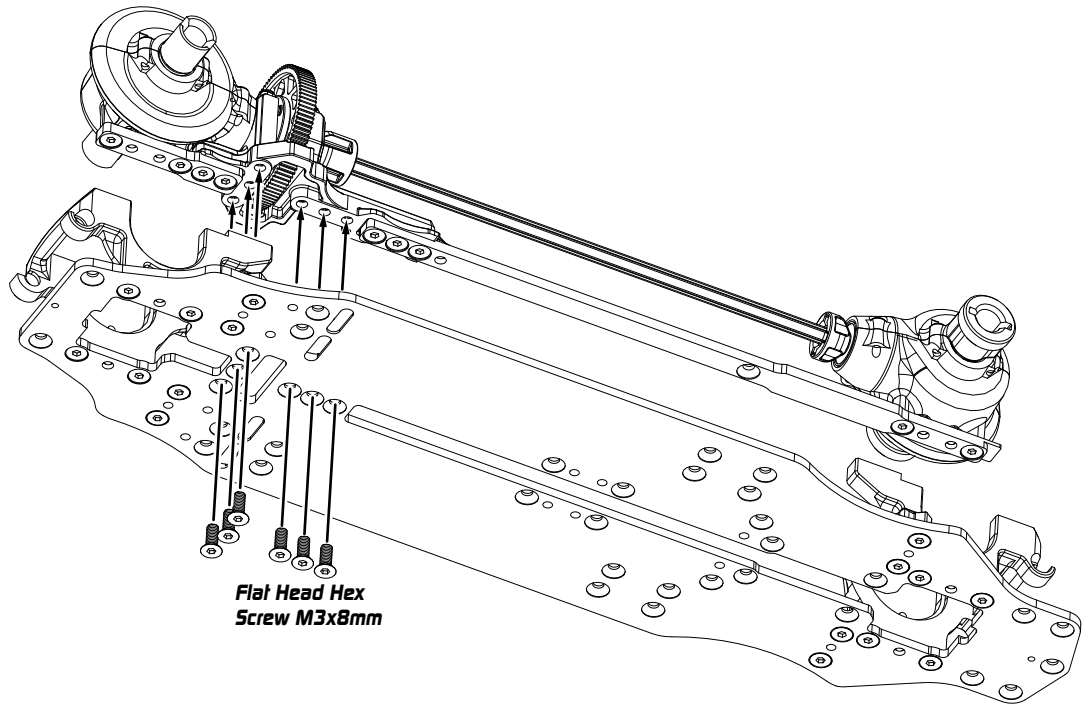

Servo unit

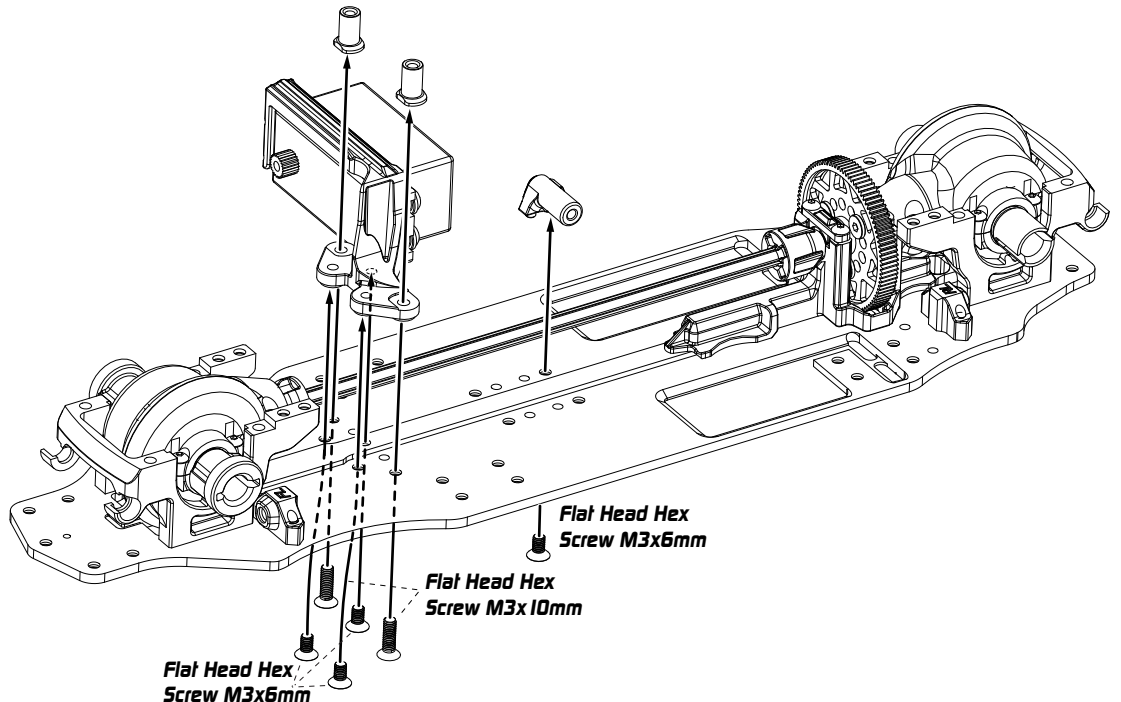
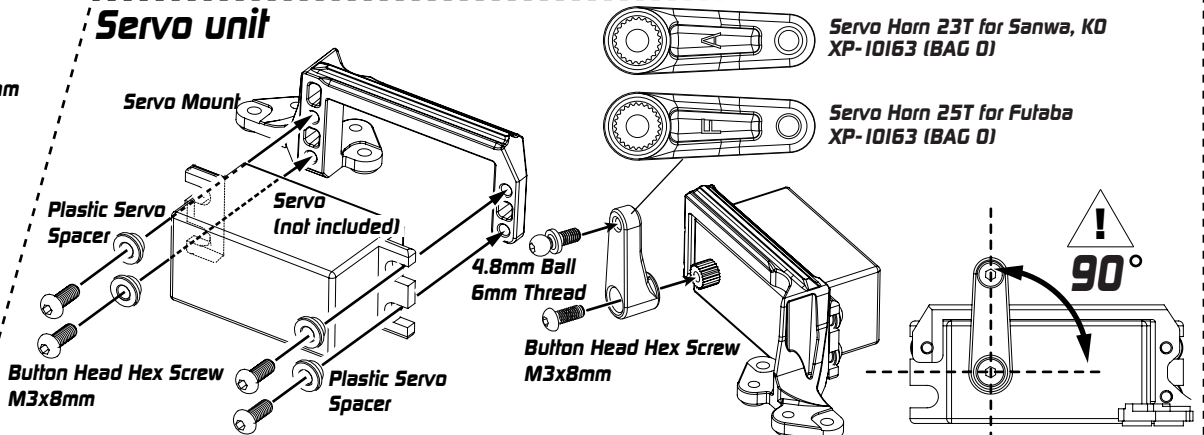

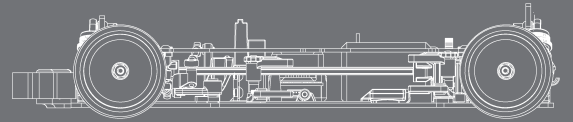

Bag F, I / Bearing Bag / HW Bag



4.8mm Ball 6mm Thread
XP-10149



Flat Head Hex Screw M3x8mm
XP-40048



Button Head Hex Screw M3x4mm
XP-40238



Button Head Hex Screw M3x6mm
XP-40037



Button Head Hex Screw M3x8mm
XP-40038



Ball Bearing 3x6x2.5mm
XP-40060



Ball Bearing 5x8x2.5mm
XP-40061

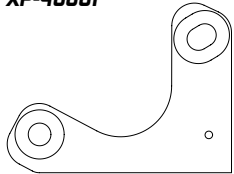

Aluminum Motor Mount Plate
XP-11000

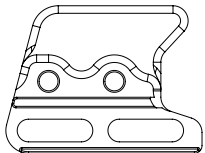

Aluminum Motor Mount Base
XP-10849

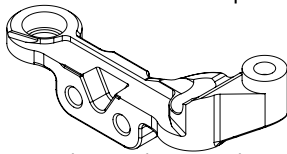

Composite Steering Set (Slim)
XP-11134
Optional : XP-10838 + XP-10859

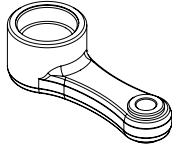

Composite Steering Set
XP-11019 Optional : XP-10650

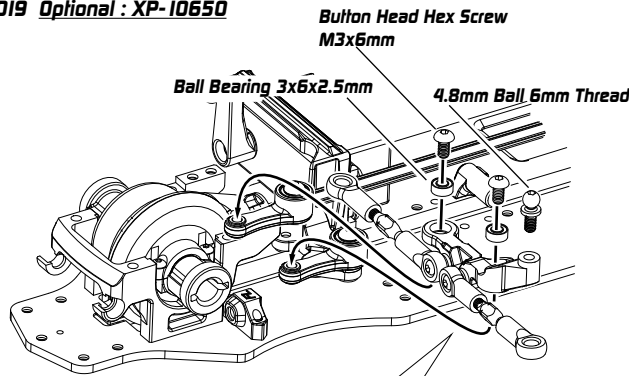

Button Head Hex Screw
M3x6mm

Ball Bearing 3x6x2.5mm

4.8mm Ball 6mm Thread

Composite Steering Plate

4.8mm Ball 6mm Thread

Steering linkage

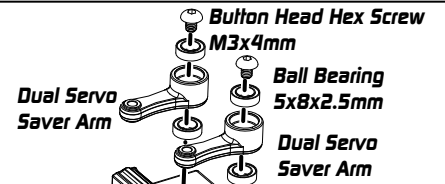

Dual Servo
Saver Arm

Button Head Hex Screw
M3x4mm

Ball Bearing
5x8x2.5mm

Dual Servo
Saver Arm

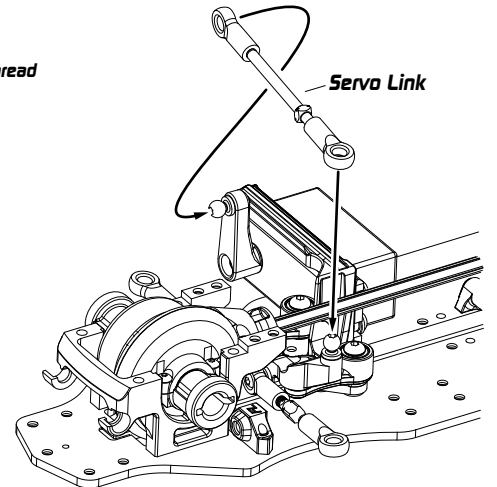

Servo Link

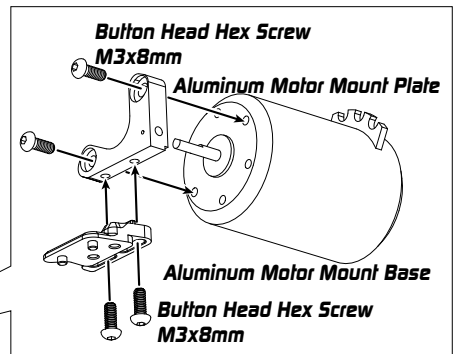

Button Head Hex Screw
M3x8mm

Aluminum Motor Mount Plate

Aluminum Motor Mount Base

Button Head Hex Screw
M3x8mm

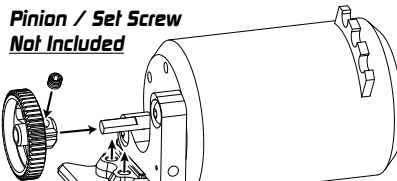

Pinion / Set Screw
Not Included

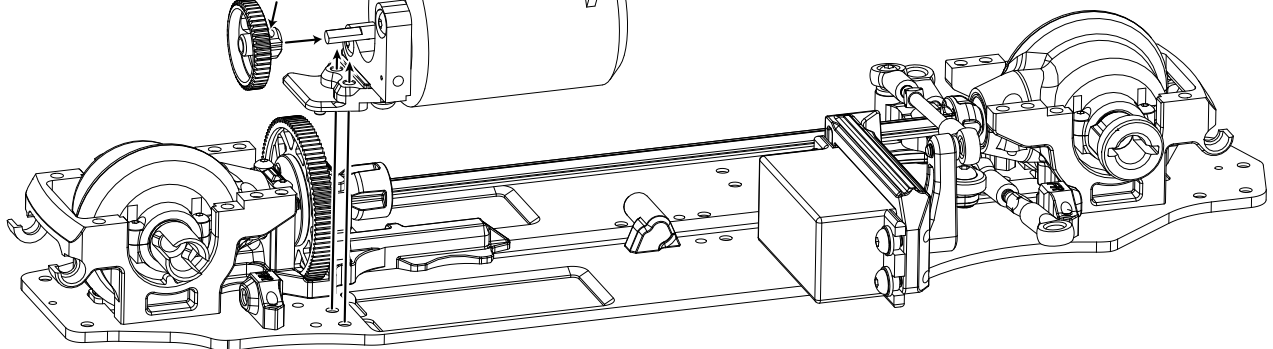

Flat Head Hex Screw
M3x8mm

9. Upper Deck

ARROW-AMIS

& Camberlink Assembly

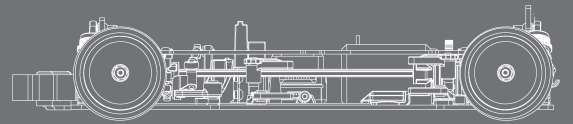

Bag J / HW / Chassis Bag

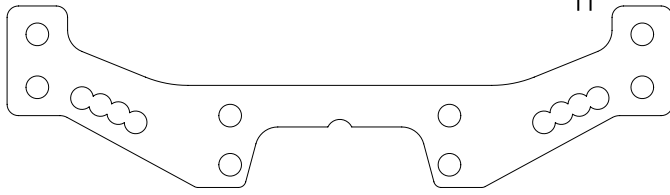

FRP Rear Shock Tower Plate
XP-11052
Optional : XP-10906

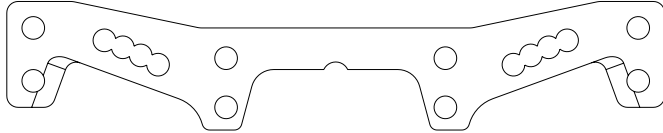

FRP Front Shock Tower Plate
XP-11051
Optional : XP-10905

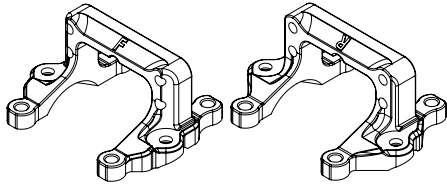

Composite Upper Bulkhead
XP-11007

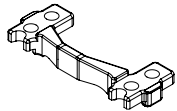

Composite Bulkhead Plate
XP-11007



4.8mm Ball Inner Thread
XP-10045



Bultron Head Hex Screw M3x8mm
XP-40038



Bultron Head Hex Screw M3x10mm
XP-40039



Flat Head Hex Screw 3x6mm
XP-40046

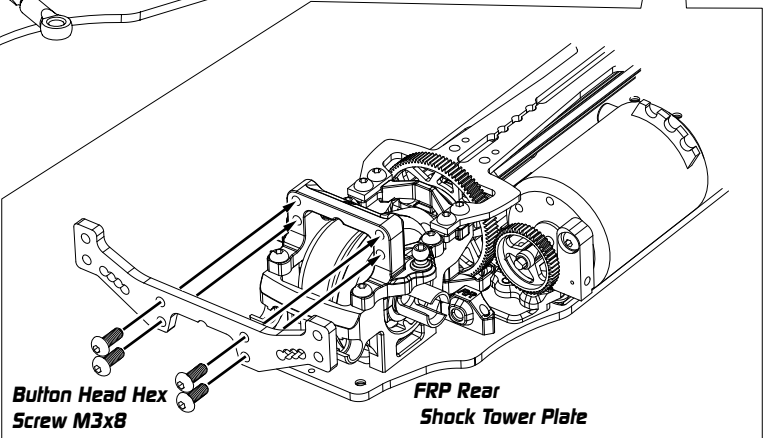
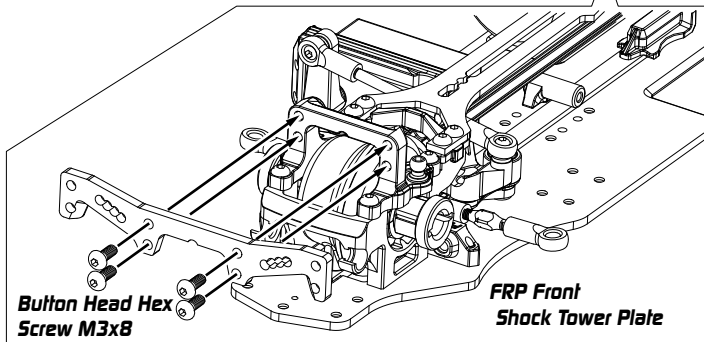
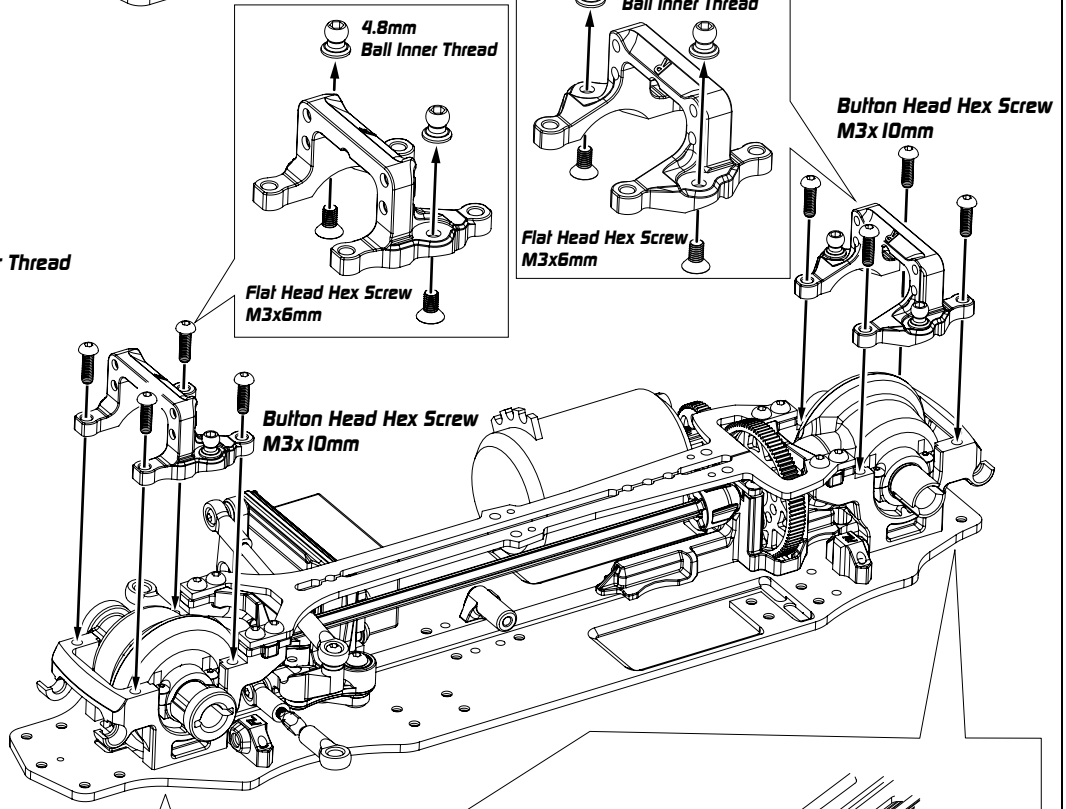
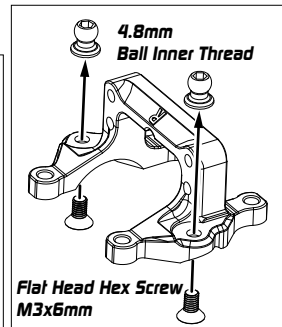
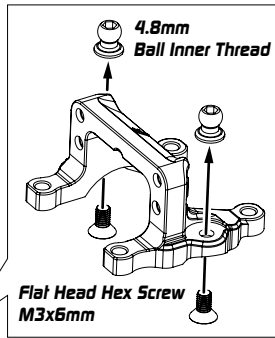
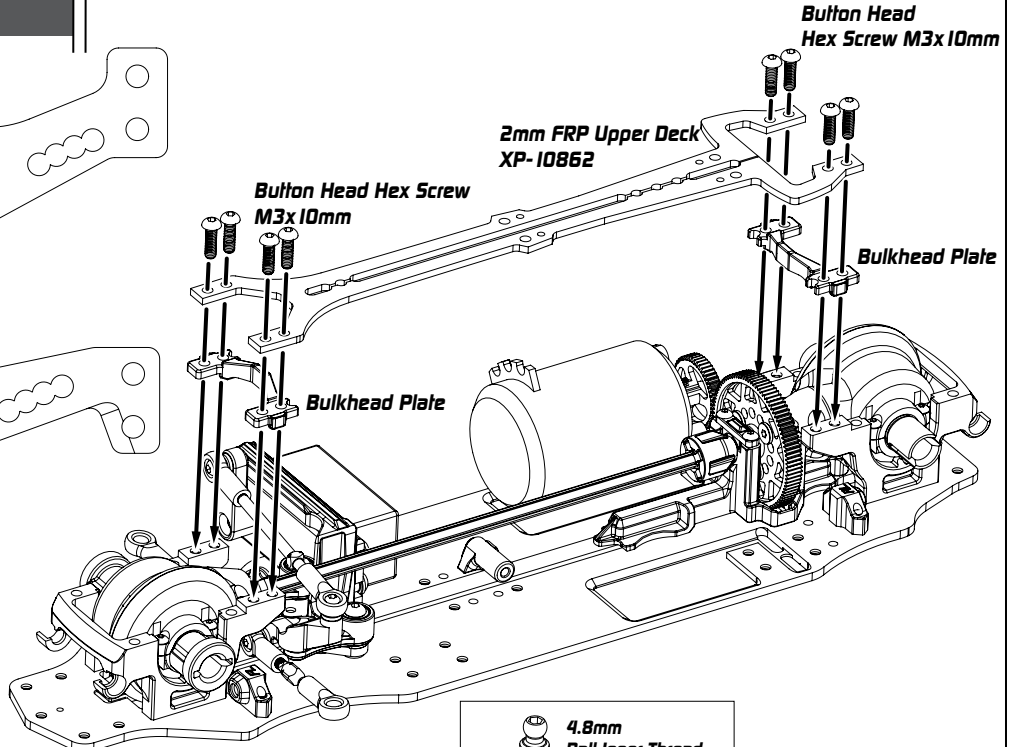

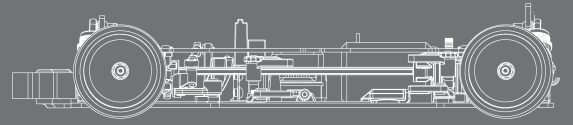

Bag K, M / HW Bag

Right

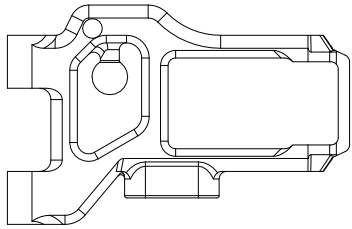

Composite Front and Rear Arm
XP-10276

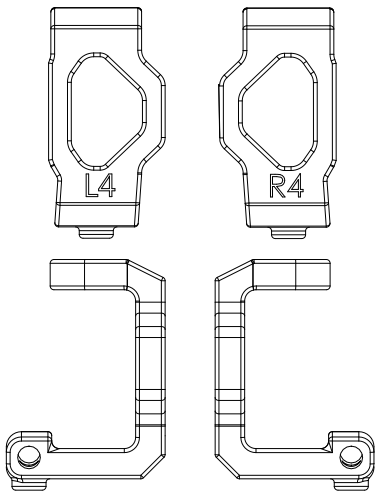

Composite C Hub 4 Degrees
XP-10278

3x18mm Flat Spot Suspension Pivot Pin
XP-10377

Button Head Hex Screw M3x10mm
XP-40039

Set Screw 3x8mm
XP-40054

Set Screw M3 x 3mm
XP-40052

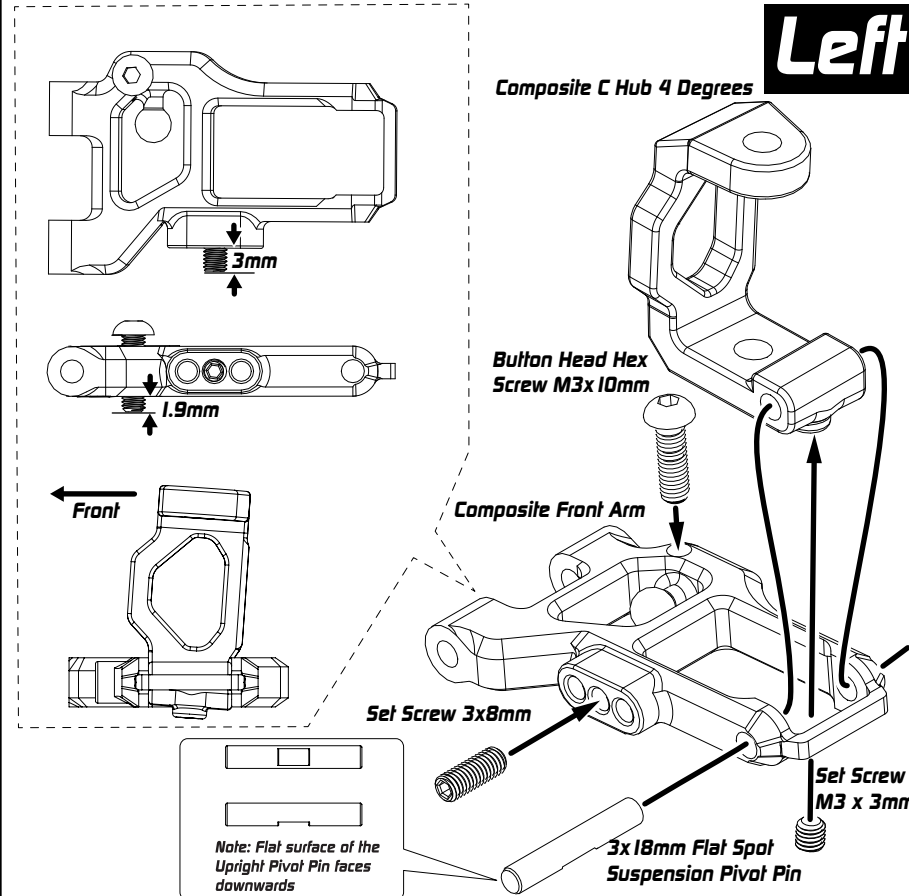
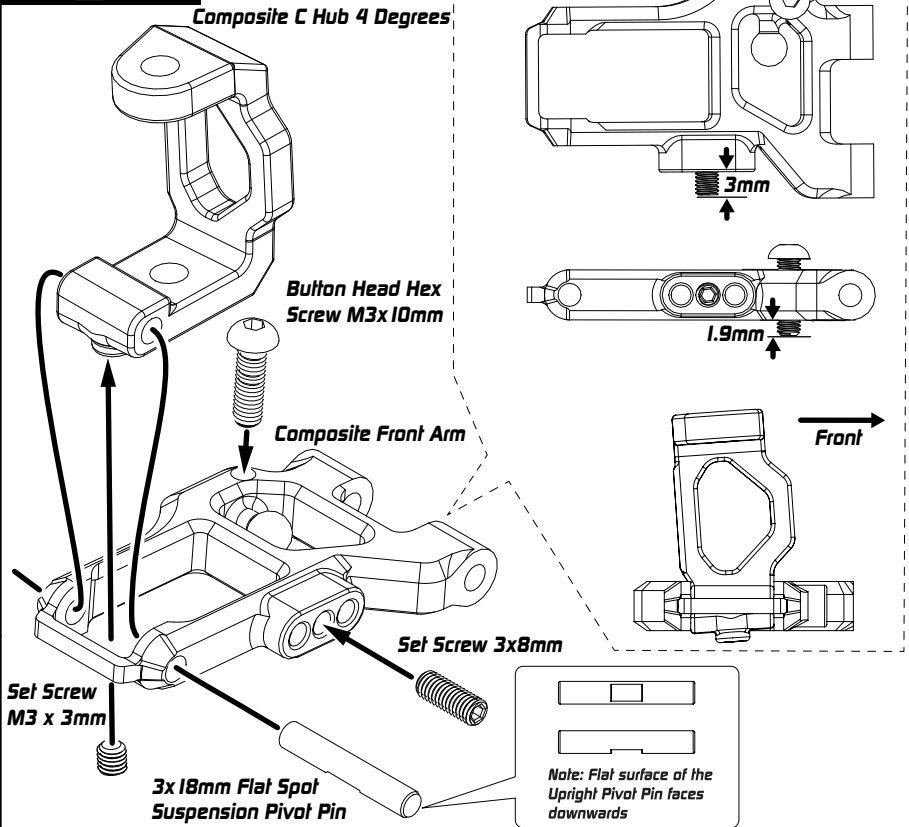

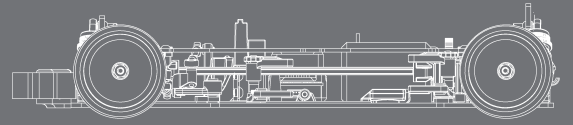

Bag L, N / Bearing / HW Bag

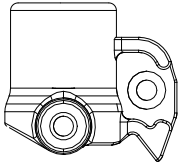

Composite Steering Block Right
XP-10277

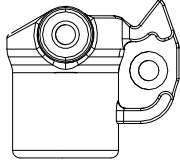

Composite Steering Block Left
XP-10277

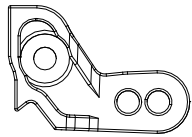

Composite Steering Block Plate Right
XP-10277

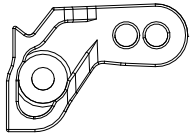

Composite Steering Block Plate Left
XP-10277



Ball Bearing 5 x 10 x 4mm
XP-40064

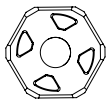

Composite Wheel Hub
XP-10262
Optional
XP-10129, XP-20015, XP-20016



Pin 2 x 9.8mm
XP-40069



Button Head Screw M3 x 8mm
XP-40038



Hex Set Screw M3 x 2mm
XP-40051

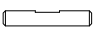

Steel 2 x 12mm Flatspot Pin for Universal
XP-40071

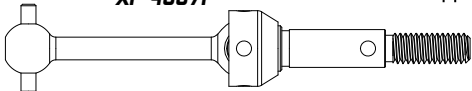

28.5mm Steel Universal Shaft
XP-10900

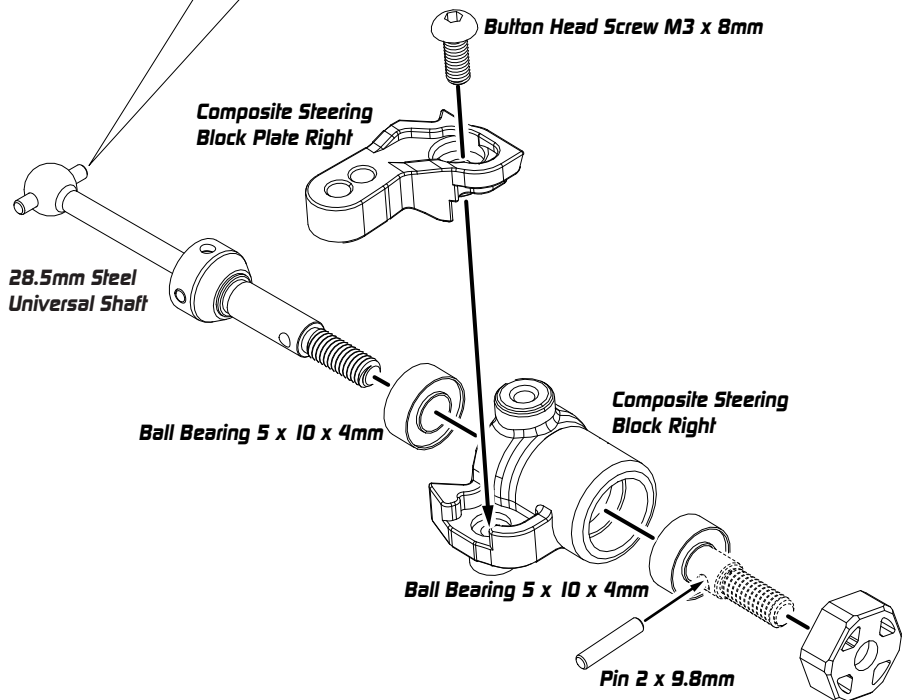
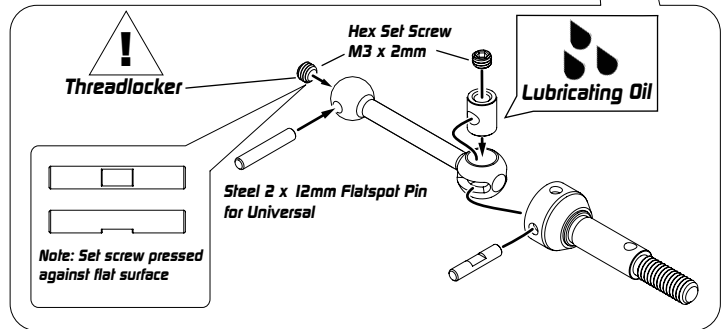
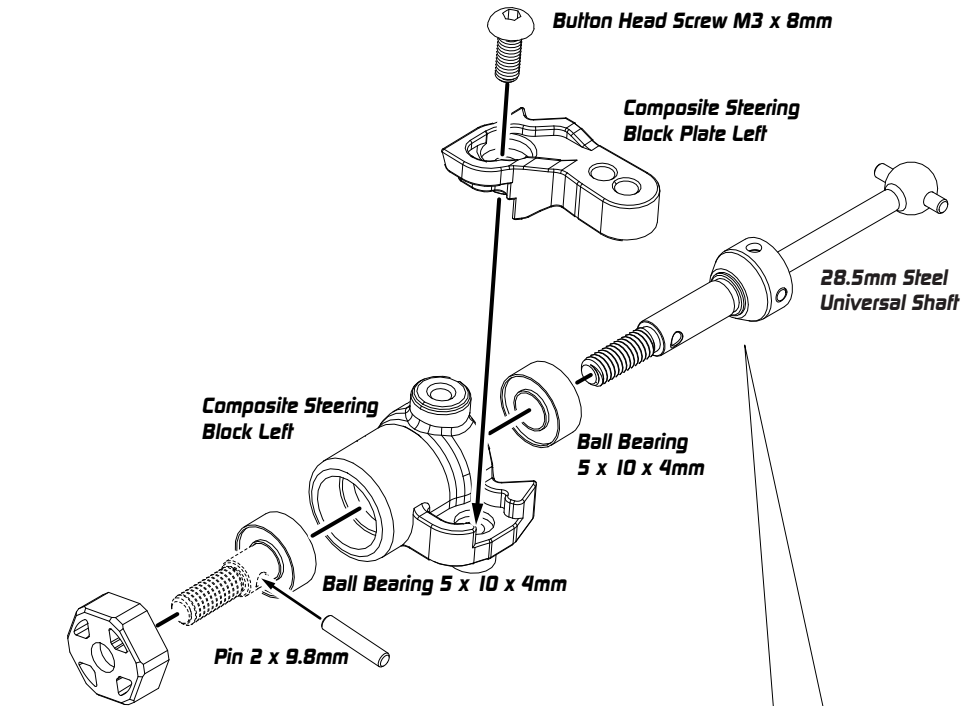

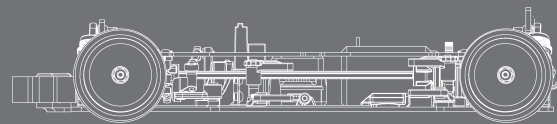

Bag N / HW Bag

Right

 King Pin
XP-10164

 King Pin Collar
XP-10164

 4.8mm Ball 6mm Thread
XP-10237

 4.8mm Ball 8mm Thread
XP-10238

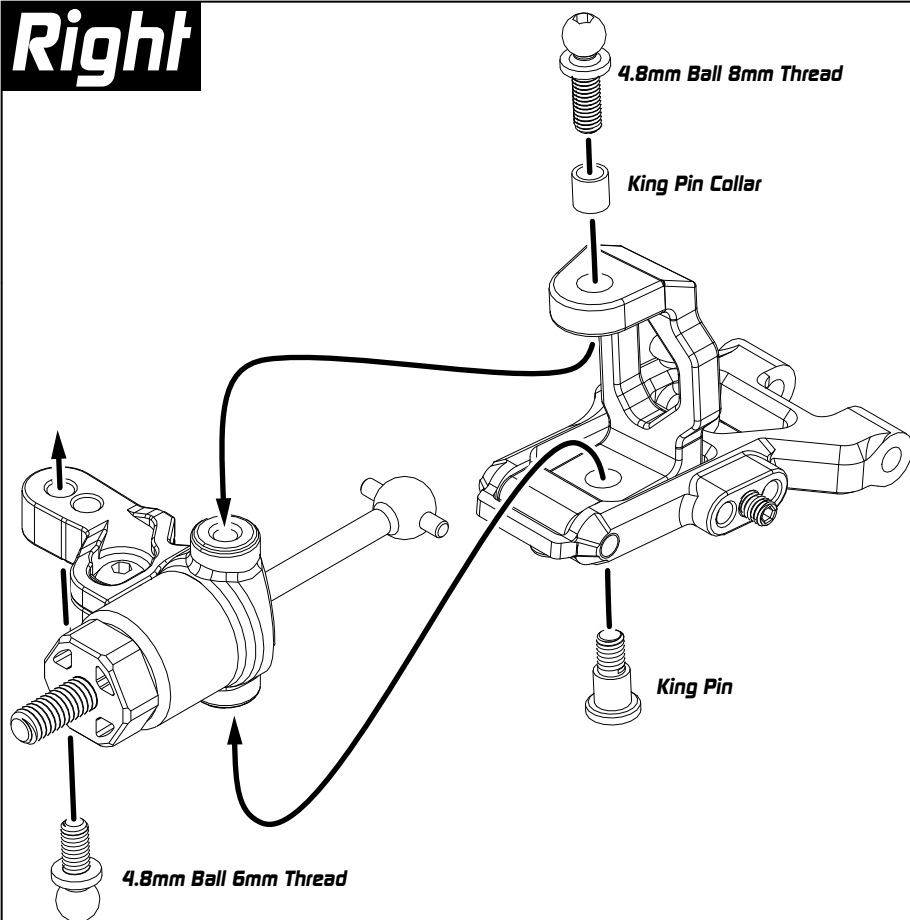

Left

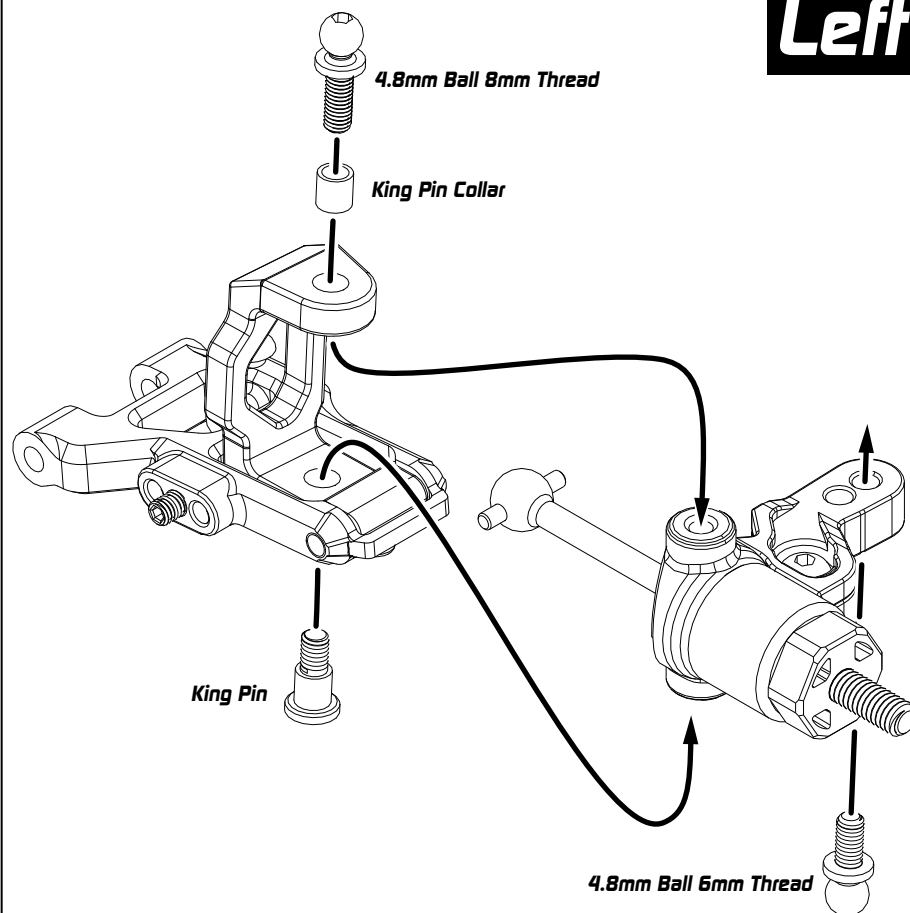

13. Front Arm & Rear Upright

ARROW-AMIS

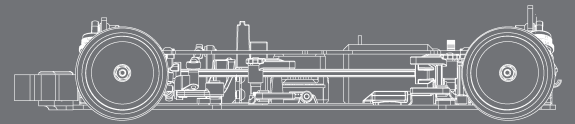

Bag L, M, O / Bearing Bag / HW Bag

Right



Composite Suspension Mount - FF
XP-10260
Optional: XP-10114 + XP-10127

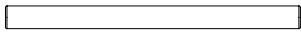

39mm Suspension Pivot Pin
XP-10875



Flat Head Hex Screw M3x8mm
XP-40048



4.8mm Ball 6mm Thread
XP-10149



Composite Shim 3x5.5x1.0mm (Bag J)
Optional: XP-10240



Composite Shim 3x5.5x2.5mm (Bag H)
Optional: XP-40158

Steel Pin 2x9.8mm
XP-40069

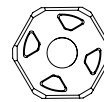

Composite Wheel Hub
XP-10262
Optional:
XP-10129, XP-20015, XP-20016

Hex Set Screw M3 x 2mm
XP-40051

Steel Pin 2.0x10mm (Flat)
XP-40174

Steel 2 x 12mm Flatspot Pin
for Universal
XP-40071

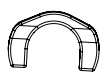

Driveshaft Protector Blade
XP-10128



Ball Bearing 5x10x4mm
XP-40064

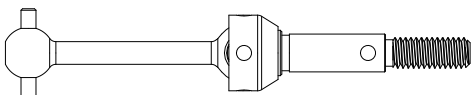

28.5mm Steel Universal Shaft
XP-10900

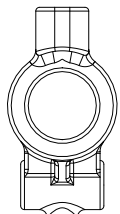
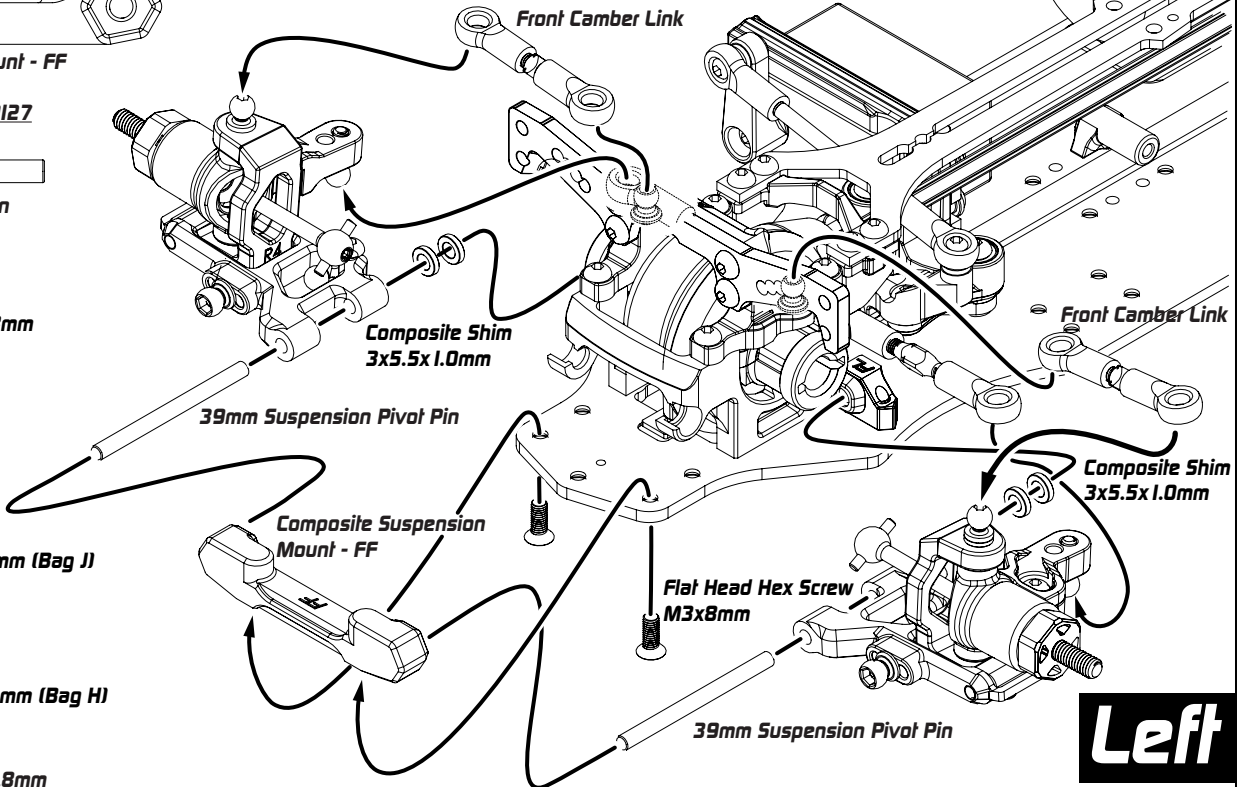

Composite Rear Upright
XP-10275
Optional: XP-10460

Left

2x

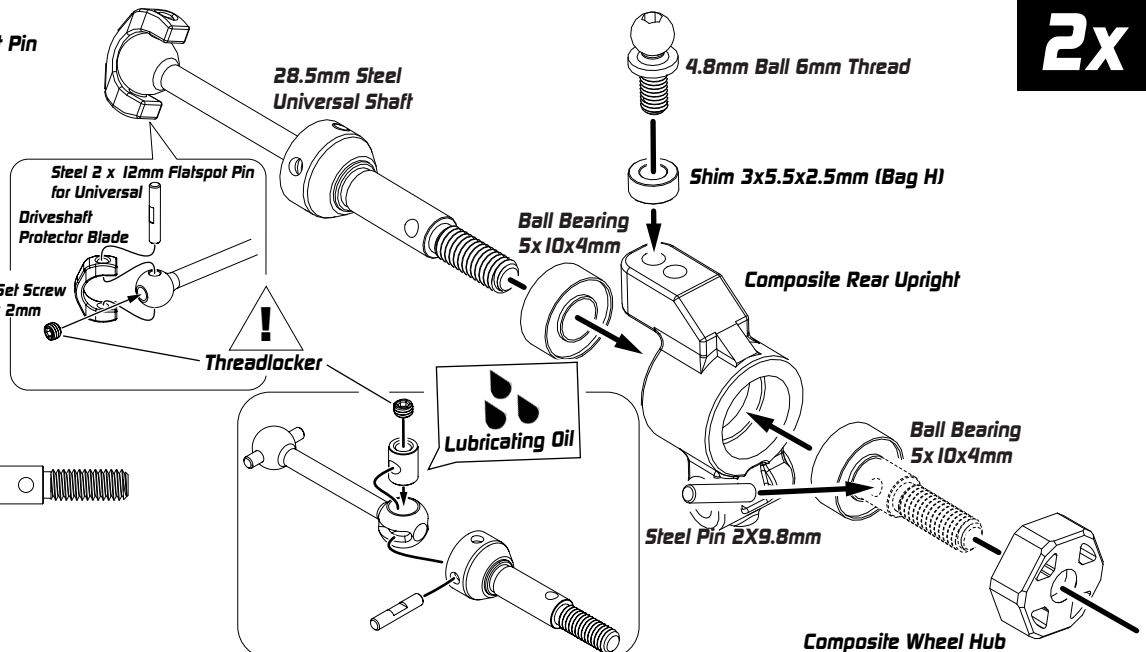

ARROW-AMIS 14. Rear Arm & Rear Upright

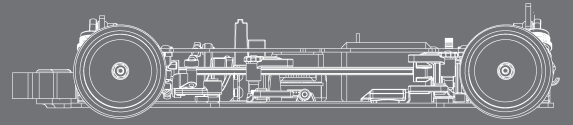

Bag K, L / Bearing Bag / HW Bag

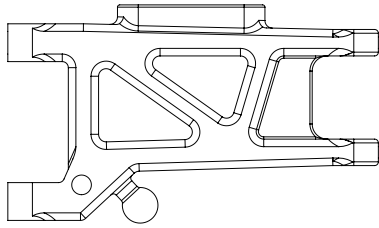

Composite Suspension Arms Rear
XP-10276

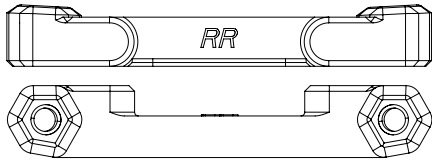

Composite Suspension Mount - RR
XP-10260 Optional: XP-10124 + XP-10127



3x42mm Suspension Pivot Pin
XP-10139



3x18mm Flat Spot Suspension Pivot Pin
XP-10377



Set Screw M3 x 3mm
XP-40052



Set Screw 3x8mm
XP-40054



Button Head Hex Screw M3x10mm
XP-40039



Flat Head Hex Screw M3x8mm
XP-40048



Composite Shim 3x5.5x4.0mm (Bag H)
Optional: XP-10241

Left

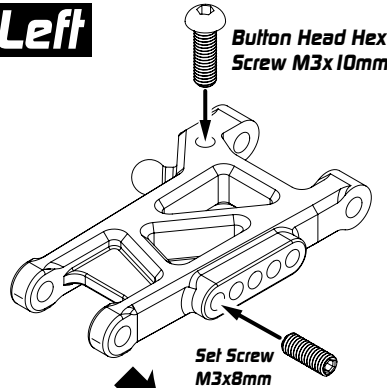

Right

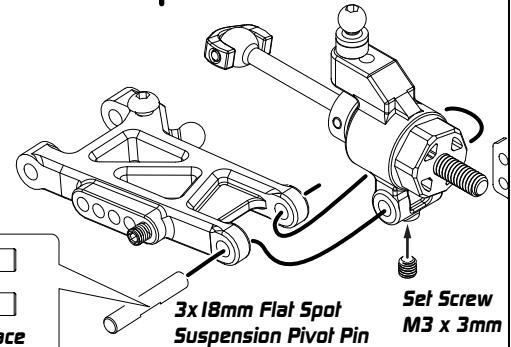
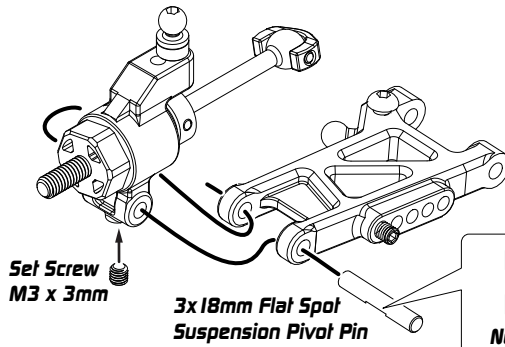
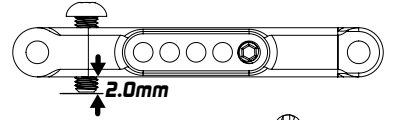
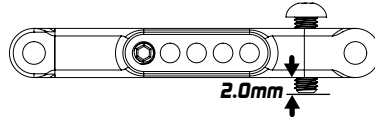
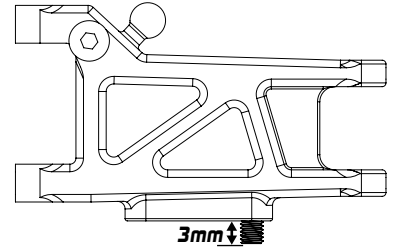
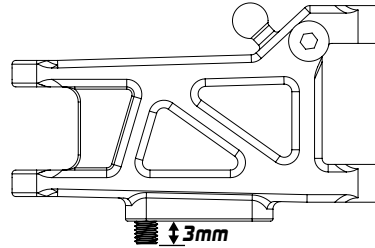
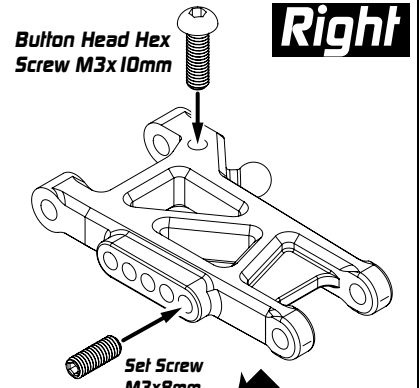



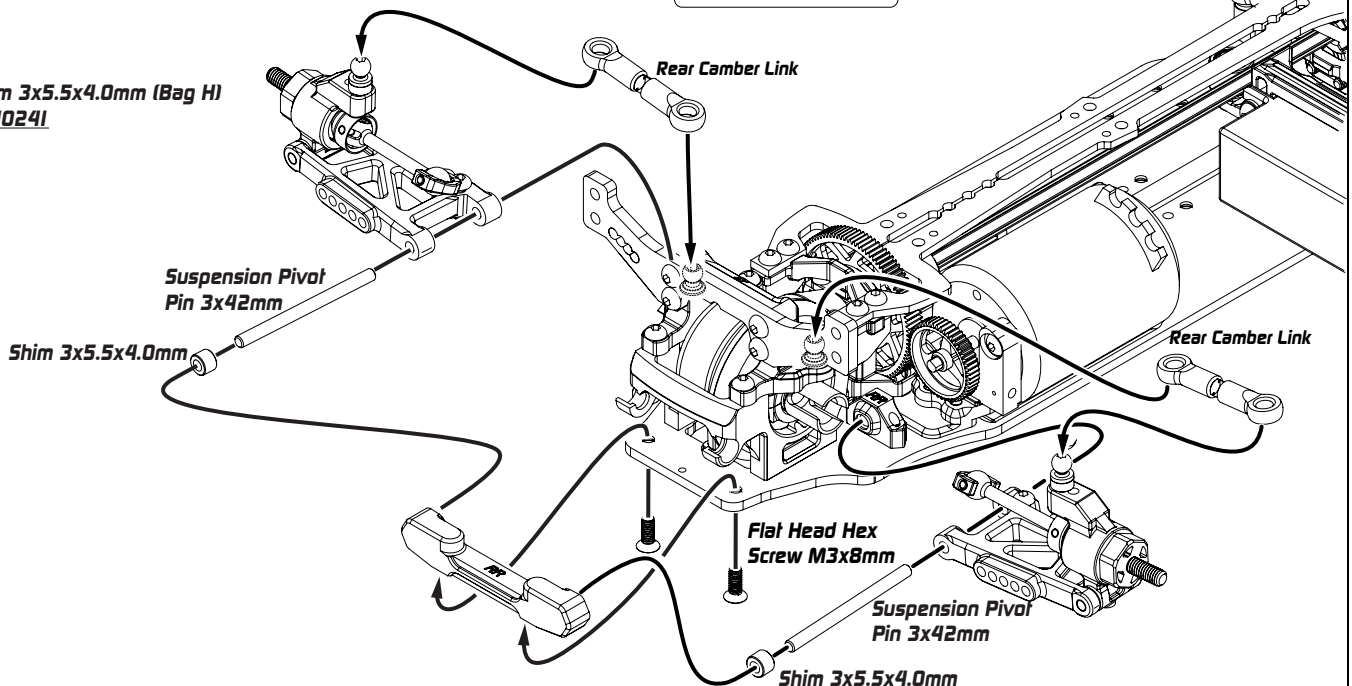

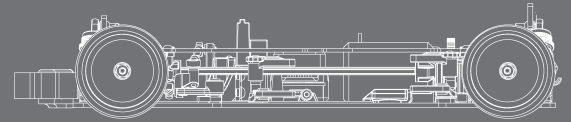

Note: Flat Surface Downwards

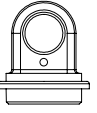
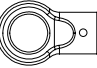
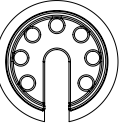
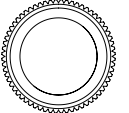
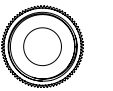
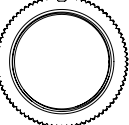
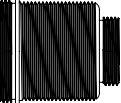
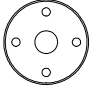

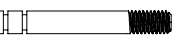
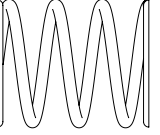

Bag P

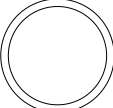
-  **Long Travel Short Shock Black Composite Short Shock Parts XP-10396**
Optional: XP-10724
-  **Long Travel Short Shock Black Composite Short Shock Parts XP-10396**
Optional: XP-10724
-  **Shock Spring Retainer XP-10396**
Optional: XP-10724
-  **Alu Upper Short Shock Cap XP-10397**
-  **Alu Lower Short Shock Cap XP-10398**
-  **Alu Short Shock Adjustable Nut XP-10399**
-  **Composite Sports Short Shock Body XP-10596**
-  **4 Hole Piston XP-10159**
-  **Shaft Cover XP-10159**
-  **5.5mm Pivot Ball XP-10121**
-  **E-Clip 2.5mm XP-40057**
-  **Short Shock Shaft XP-10582**
-  **Stiff Shock Spring Pink XP-10170**
-  **Shock Absorber Membrane XP-10147**
-  **Shock O-Ring XP-10160**
-  **O Ring For Spring Adjust Nut XP-10607**

4x

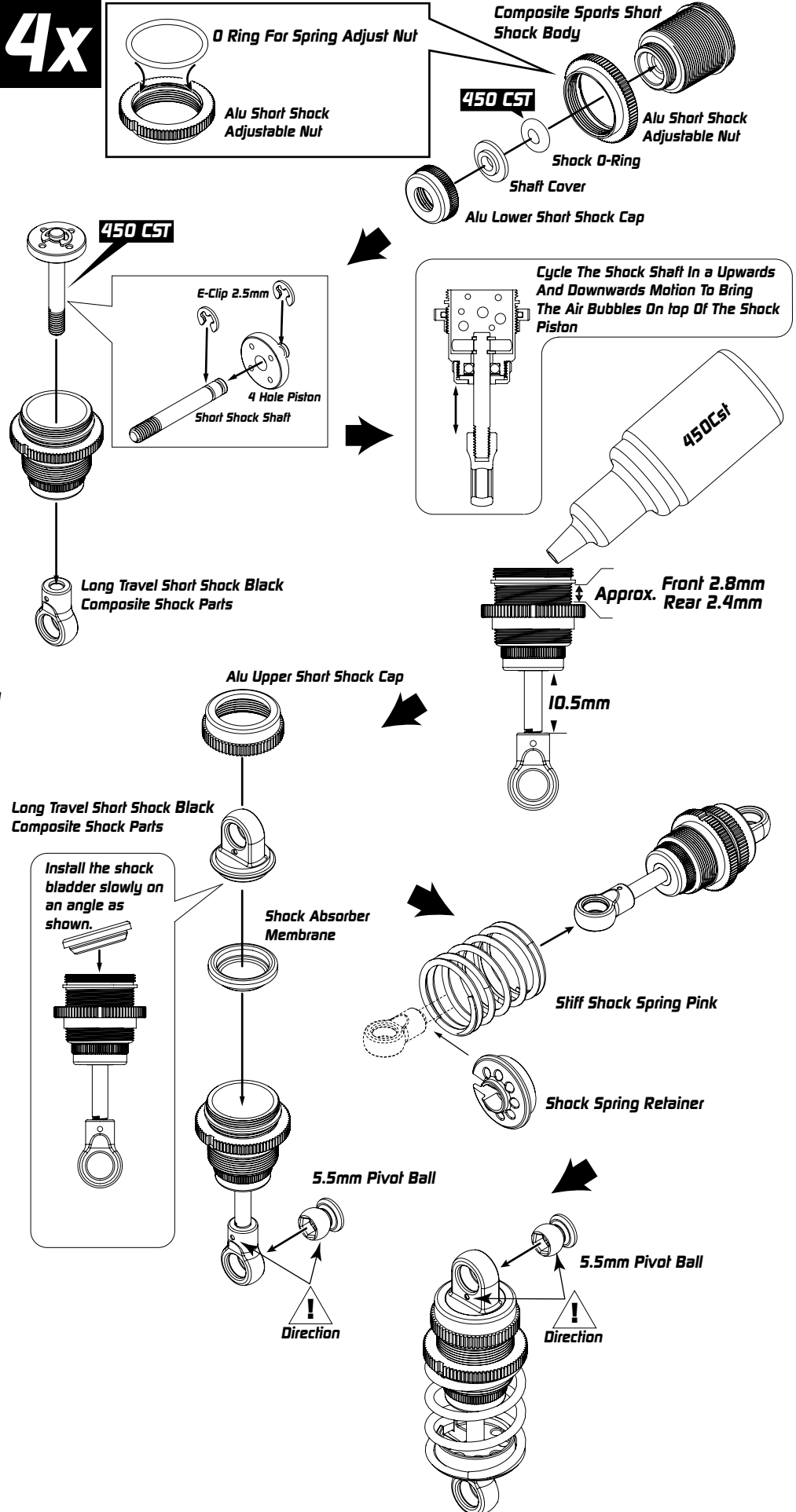

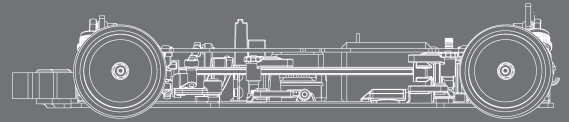

Bag Q / HW Bag

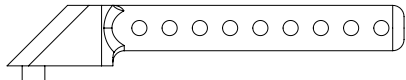
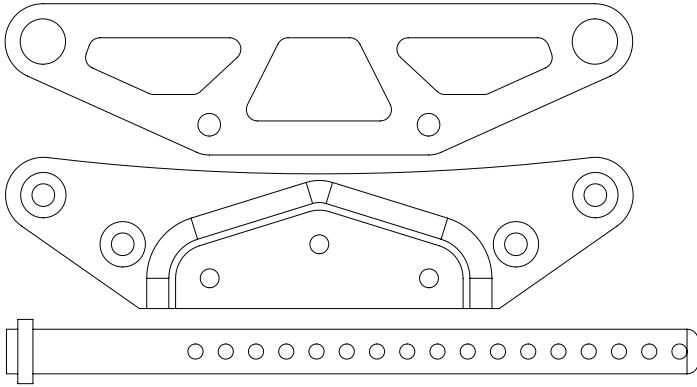

**Bumper Body Post
XP-10863**

**Bulfton Head Hex Screw M3x6mm
XP-40037**

**Flat Head Hex Screw M3x8mm
XP-40048**

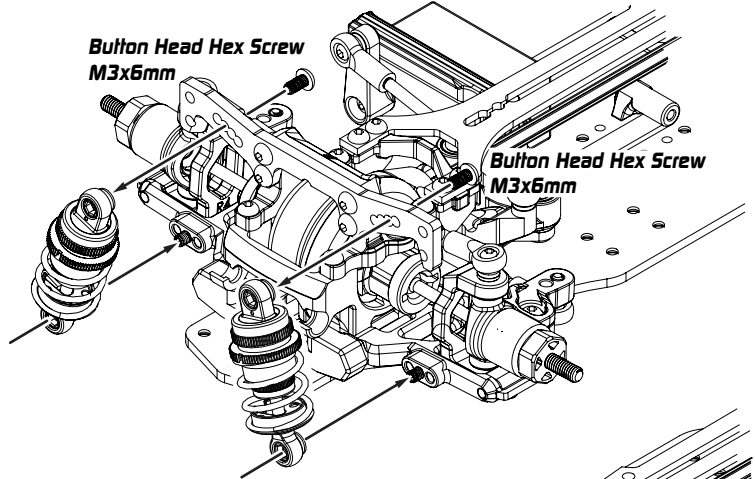

**Bulfton Head Hex Screw
M3x6mm**

**Bulfton Head Hex Screw
M3x6mm**

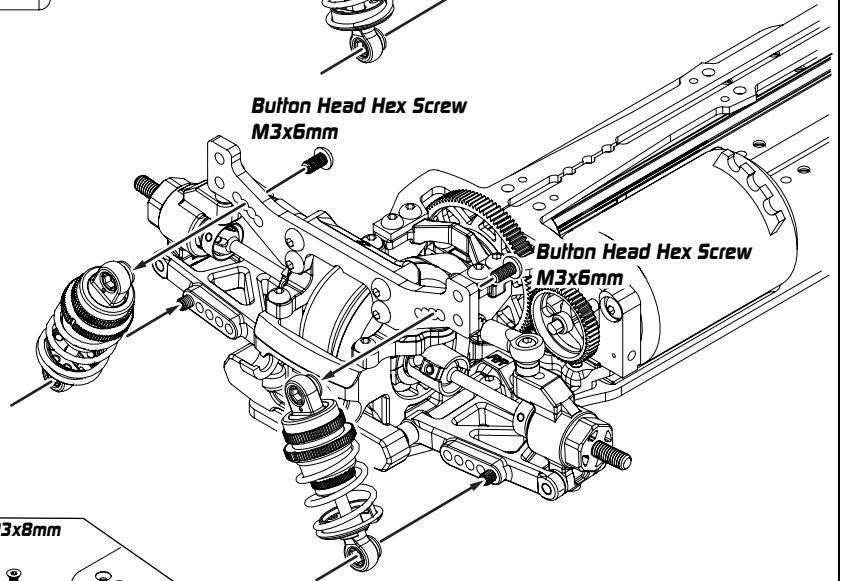

**Bulfton Head Hex Screw
M3x6mm**

**Bulfton Head Hex Screw
M3x6mm**

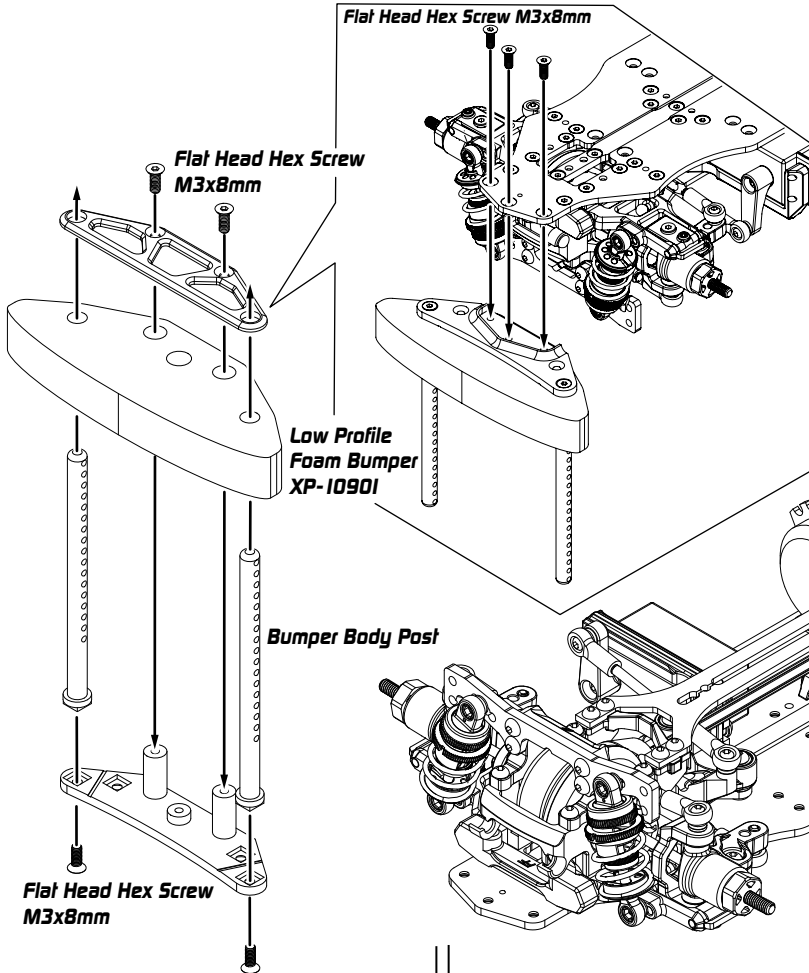

Flat Head Hex Screw M3x8mm

**Flat Head Hex Screw
M3x8mm**

**Low Profile
Foam Bumper
XP-10901**

Bumper Body Post

**Flat Head Hex Screw
M3x8mm**

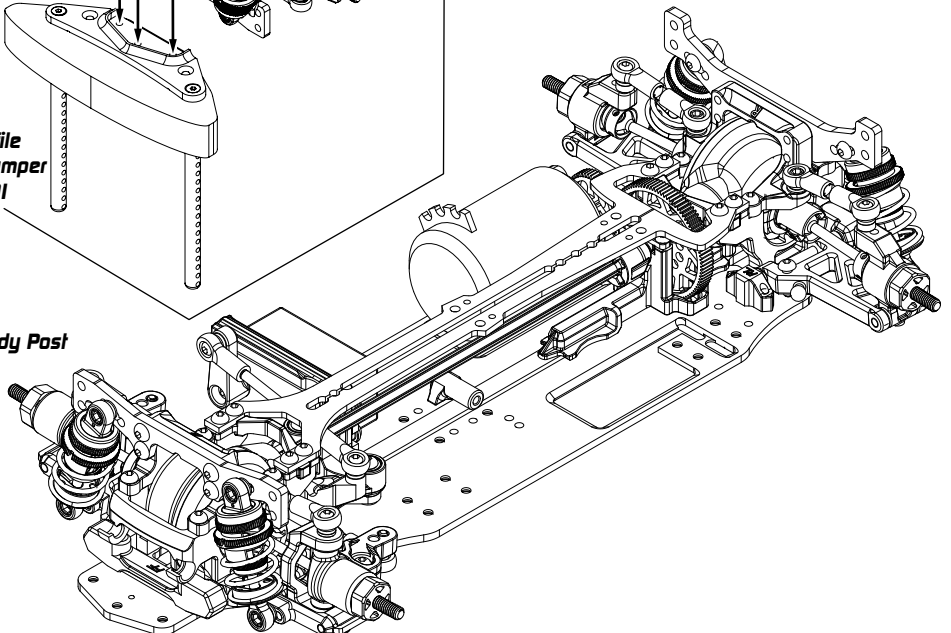

17. Battery Holder & Fan Mount

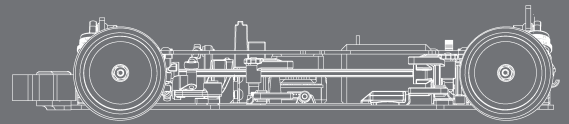

Bag Q , R / HW Bag

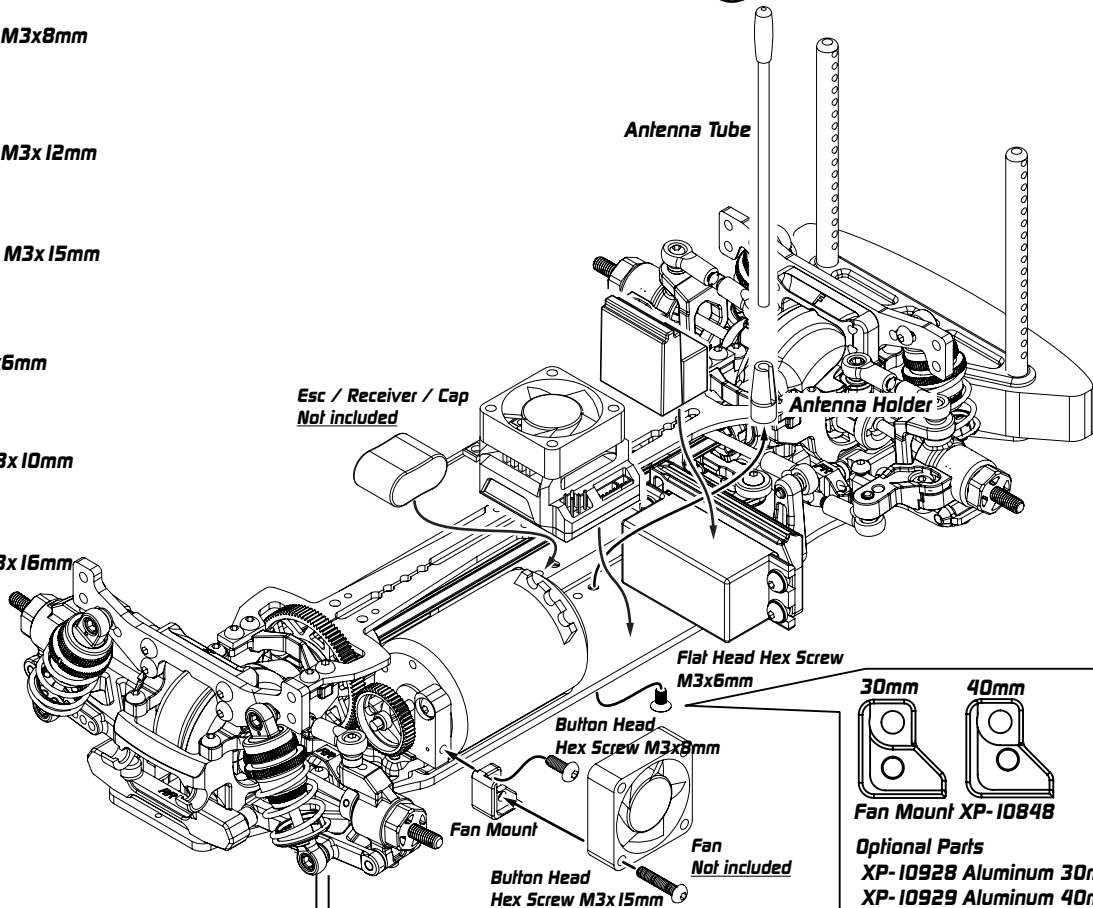
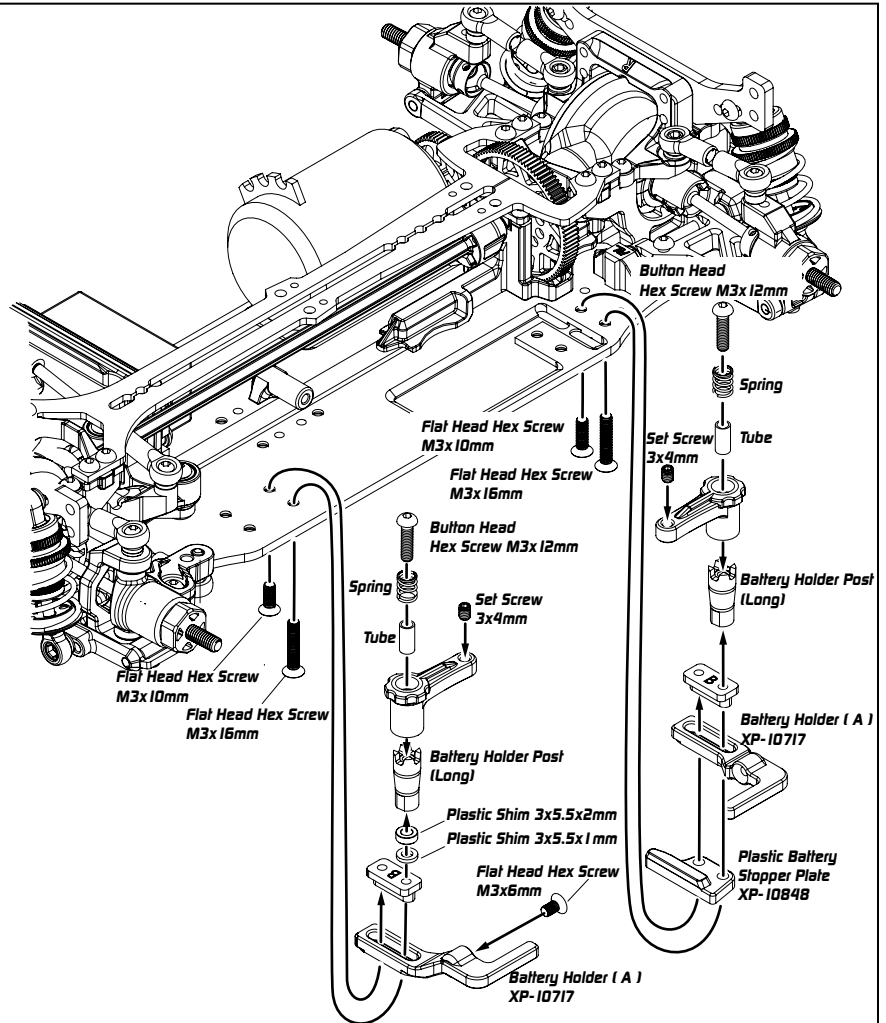
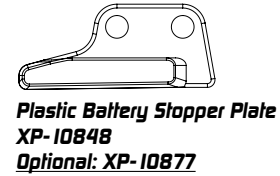
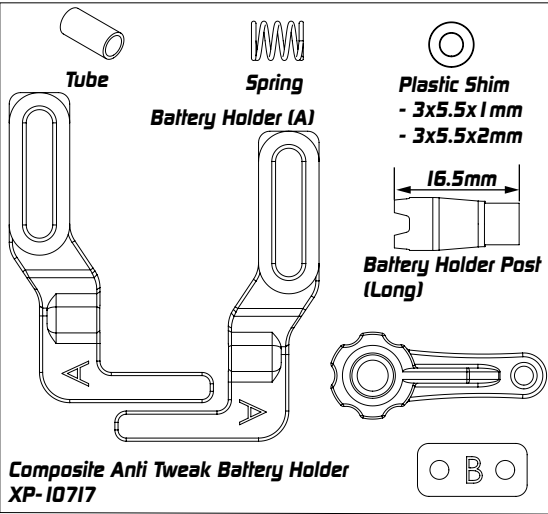

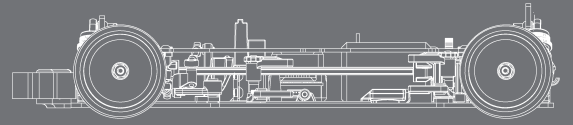

HW Bag



**Button Head Hex Screw M3x8mm
XP-40038**

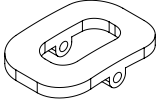

**Body Height Support
XP-10863**

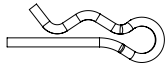

**Body Clips
XP-10055**



**Lock Nut 7mm
XP-40068**

**Lock Nut 7mm
XP-40068**

**Wheel/Tires
Not Included**

**Lock Nut 7mm
XP-40068**

**Wheel/Tires
Not Included**

**Lock Nut 7mm
XP-40068**

**Wheel/Tires
Not Included**

**Battery
Not Included**

**Lock Nut 7mm
XP-40068**

**Wheel/Tires
Not Included**

**Body Clips
Body Height Support**

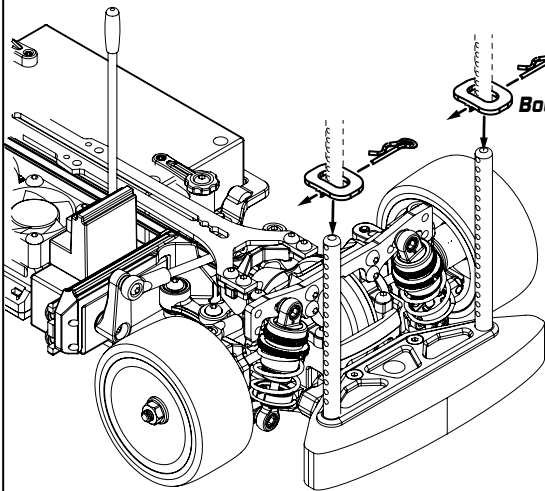

Vertical Rear Body Post

**Body Clips
Body Height Support
Body Clips**

**Button Head Hex Screw
M3x8mm**

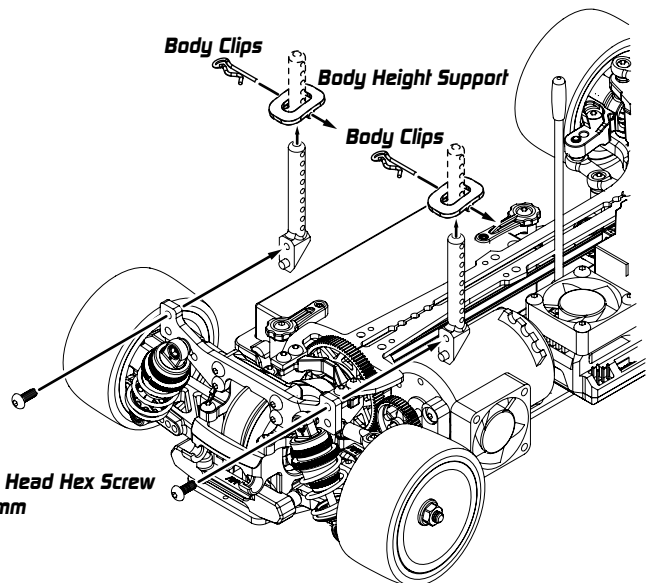

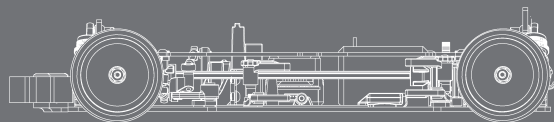
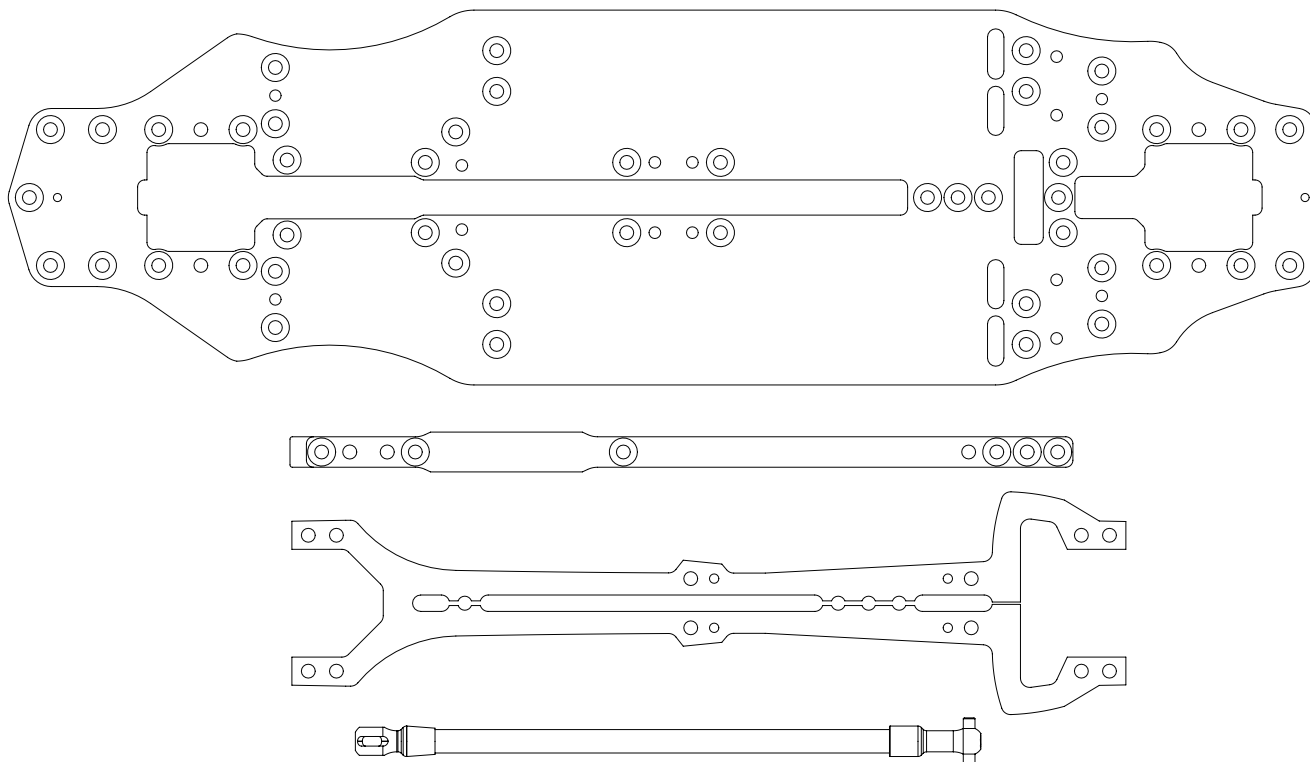
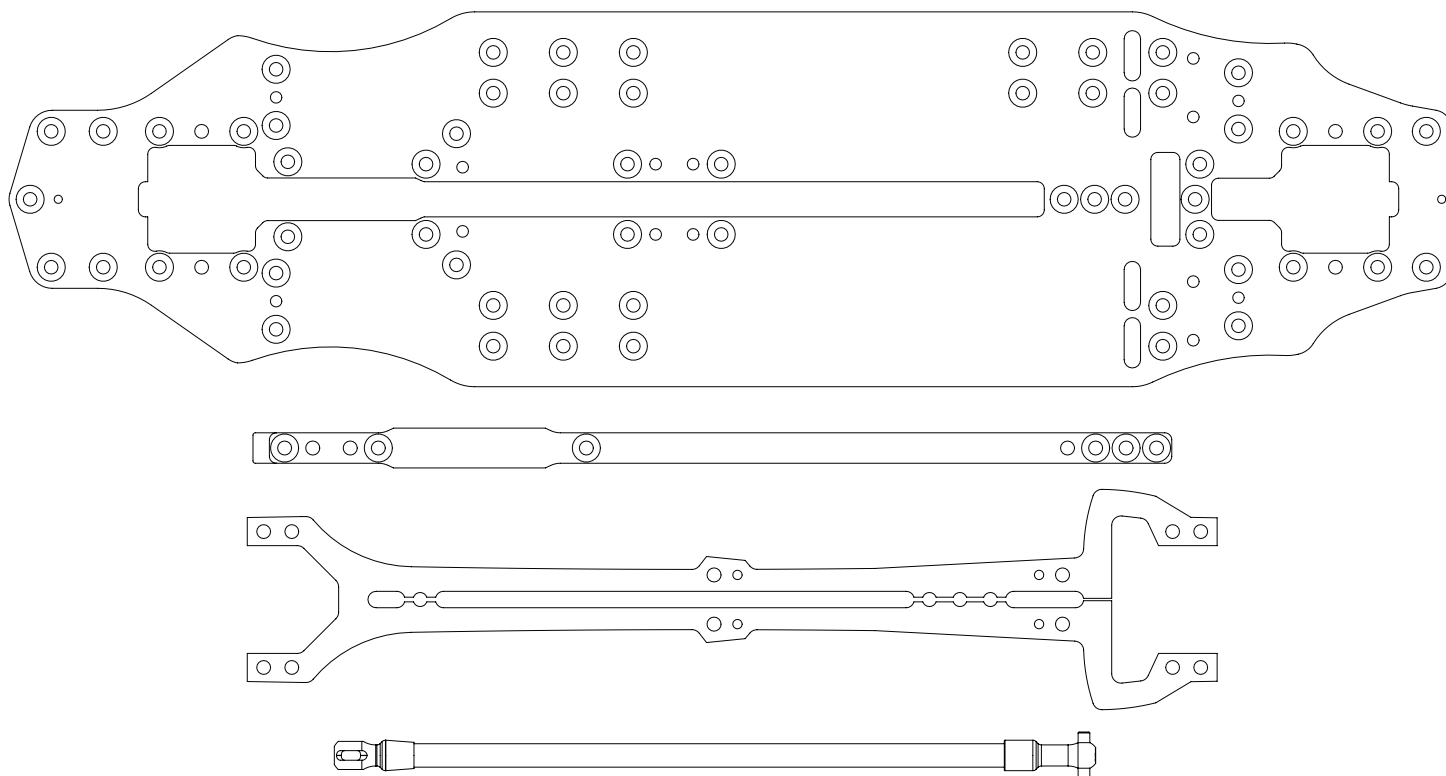
**XP-11108 - Graphite Conversion Kit for 210mm****XP-11109 - Graphite Conversion Kit for 239mm**

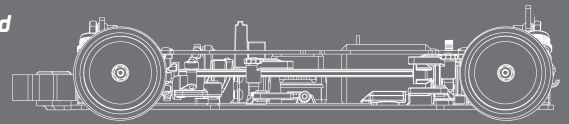

Driver _____ Track Surface _____ Track Temperature _____
 Date _____ Track Traction _____ Result _____ Air Temperature _____
 Track _____ Country _____ Best Lap _____ Humidity _____ Remark _____

Front	Suspension Arm	C-Hub	Steering Block	Rear Hub	N = Normal H = Hard	Rear	Remark
<input type="checkbox"/> N <input type="checkbox"/> H	<input checked="" type="checkbox"/> N <input type="checkbox"/> H	<input checked="" type="checkbox"/> N <input type="checkbox"/> H	<input checked="" type="checkbox"/> N <input type="checkbox"/> H	<input checked="" type="checkbox"/> N <input type="checkbox"/> H			
<p>Shim 0 mm Shim 0 mm Shim 0 mm Shim 2.5 mm</p>							
<p>5.2 5.0 4.8 4.6 4.4 4.2 4 4 4.2 4.4 4.6 4.8 5.0 5</p>							
<p>Camber Link</p> <p>Item No: _____ Camber 1.5 °</p> <p>XP: _____ 5 mm Ride Height 5 mm</p> <p>5 mm Hex Offset 5 mm</p> <p>1.3 mm Sway Bar 1.3 mm</p> <p>38 mm Camber Link Distance 42 mm</p>							

<p>Front Toe Out 0.5 °</p> <p>Lower Arm Shim 0 mm</p> <p>Wheelbase Shim FF 0 mm FR 2 mm</p>	<p>Front Tire Additive Area</p> <p>Bump Steering Shim</p> <p>Shim 0 mm</p> <p>Inserts -- mm</p> <p>Shim 0 mm</p>	<p>Rear Toe In 3</p> <p>Rear Tire Additive Area</p> <p>Lower Arm Shim 0 mm</p> <p>Wheelbase Shim RF 0 mm RR 4 mm</p>
<p>Standard Battery</p> <p>Short Battery (Forward Position)</p> <p>Short Battery (Backward Position)</p>		

Suspension Mount Setup	FF	FR	RF	RR
<input type="checkbox"/> 1 <input type="checkbox"/> Aluminium <input type="checkbox"/> 0.5 <input type="checkbox"/> Brass Mount Spacer 0 mm	<input type="checkbox"/> 1 <input type="checkbox"/> Aluminium <input type="checkbox"/> 0.5 <input type="checkbox"/> Brass Mount Spacer 0 mm	<input type="checkbox"/> 1 <input type="checkbox"/> Aluminium <input checked="" type="checkbox"/> Spill <input type="checkbox"/> 0.5 <input type="checkbox"/> Brass <input type="checkbox"/> Solid Mount Spacer 0 mm	<input type="checkbox"/> 1 <input type="checkbox"/> Aluminium <input checked="" type="checkbox"/> Spill <input type="checkbox"/> 0.5 <input type="checkbox"/> Brass <input type="checkbox"/> Solid Mount Spacer 0 mm	<input type="checkbox"/> 1 <input type="checkbox"/> Aluminium <input type="checkbox"/> 0.5 <input type="checkbox"/> Brass Mount Spacer 0 mm

Flex Control

Upper Deck Thick 2 mm

FRP Chassis
 Graphite Chassis
 Aluminum Chassis

Upper Deck Stiffener (Plastic)
 Upper Deck Stiffener (Aluminum)

Damper Setup

Front	Rear
XP-10170(Pink) Spring	XP-10170(Pink)
450cst Oil	450cst
50% Rebound	50%
4 Piston	4
10.5 Length	10.5

Transmission Setup

Front Spool _____ Rear Gear Diff. _____

Diff. 9 Oil 5000cst / 1.1 g

Bevel Gear _____

Spur 64 P / 94 T Pinon _____ P / T _____

Final Drive Ratio _____ : 1

Formula
 Final Drive Ratio = $\left(\frac{\text{Spur Pinon}}{\text{Internal Ratio}}\right) \times 2.353 : 1$

Others

Servo _____ Tires _____

Esc _____

Motor _____

Additive _____

Body _____

Rear Wing _____

Remark

Default Setup



Set-Up Sheet

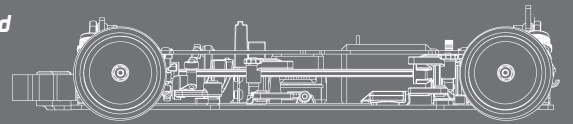

Driver _____ Track Surface _____ Track Temperature _____
 Date _____ Track Traction _____ Result _____ Air Temperature _____
 Track _____ Country _____ Best Lap _____ Humidity _____ Remark _____

Front	Suspension Arm	C-Hub	Steering Block	Rear Hub	N = Normal H = Hard	Rear	Remark
<input type="checkbox"/> N <input type="checkbox"/> H	<input type="checkbox"/> N <input type="checkbox"/> H	<input type="checkbox"/> N <input type="checkbox"/> H	<input type="checkbox"/> N <input type="checkbox"/> H	<input type="checkbox"/> N <input type="checkbox"/> H	<input type="checkbox"/> N <input type="checkbox"/> H		
<p>Shim mm</p> <p>Shim mm</p> <p>Shim mm</p> <p>Shim mm</p>							
<p>5.2 5.0 4.8 4.6 4.4 4.2 4</p> <p>4 4.2 4.4 4.6 4.8 5.0 5</p>							
<p>Camber Link</p> <p>Item No: _____ mm DownStop _____ mm</p> <p>XP: _____ mm Camber _____ mm</p> <p>mm Ride Height _____ mm</p> <p>mm Hex Offset _____ mm</p> <p>mm Sway Bar _____ mm</p> <p>mm Camber Link Distance _____ mm</p> <p>Item No: _____ mm</p> <p>XP: _____ mm</p>							

<p>Front Toe Out _____</p> <p>Lower Arm Shim _____ mm</p> <p>Wheelbase Shim</p> <p>FF _____ mm</p> <p>FR _____ mm</p>	<p>Front Tire Additive Area</p> <p>Bump Steering Shim</p> <p>Shim _____ mm</p> <p>Inserts _____ mm</p> <p>Shim _____ mm</p>	<p>Rear Toe In _____</p> <p>Lower Arm Shim _____ mm</p> <p>Wheelbase Shim</p> <p>RF _____ mm</p> <p>RR _____ mm</p>	<p>Rear Tire Additive Area</p> <p>Standard Battery</p> <p>Short Battery (Forward Position)</p> <p>Short Battery (Backward Position)</p>
---	---	---	---

Suspension Mount Setup	FF	FR	RF	RR
<input type="checkbox"/> 1 <input type="checkbox"/> Aluminium <input type="checkbox"/> 0.5 <input type="checkbox"/> Brass	<input type="checkbox"/> 1 <input type="checkbox"/> Aluminium <input type="checkbox"/> Spill <input type="checkbox"/> 0.5 <input type="checkbox"/> Brass <input type="checkbox"/> Solid	<input type="checkbox"/> 1 <input type="checkbox"/> Aluminium <input type="checkbox"/> Spill <input type="checkbox"/> 0.5 <input type="checkbox"/> Brass <input type="checkbox"/> Solid	<input type="checkbox"/> 1 <input type="checkbox"/> Aluminium <input type="checkbox"/> 0.5 <input type="checkbox"/> Brass	
Mount Spacer _____ mm	Mount Spacer _____ mm	Mount Spacer _____ mm	Mount Spacer _____ mm	

Flex Control

Upper Deck Thick _____ mm

Graphite Chassis
 Aluminum Chassis

Upper Deck Stiffener (Plastic)
 Upper Deck Stiffener (Aluminum)

Damper Setup

Foam Insert Hole In Cap

Front _____ Spring _____
 Rear _____ Oil _____
 _____ Rebound _____
 _____ Piston _____
 _____ Length _____

Transmission Setup

Front	Rear
Diff. _____	Diff. _____
/ 9 Oil _____	/ 9 Oil _____
Bevel Gear _____	Bevel Gear _____
Spur P/ T Pinon P/ T	Spur P/ T Pinon P/ T
Final Drive Ratio _____ : 1	Final Drive Ratio _____ : 1

Formula
 Final Drive Ratio = $\left(\frac{\text{Spur Pinon}}{\text{Internal Ratio}} \times 2.353\right) : 1$

Others

Servo _____ Tires _____
 Esc _____
 Motor _____
 Additive _____
 Body _____
 Rear Wing _____

Remark



Manuals & Setups
www.rc-xpress.com/manuals-setups-download

Latest Parts & Hop-Ups Information
www.rc-xpress.com/arrow-am-1-parts

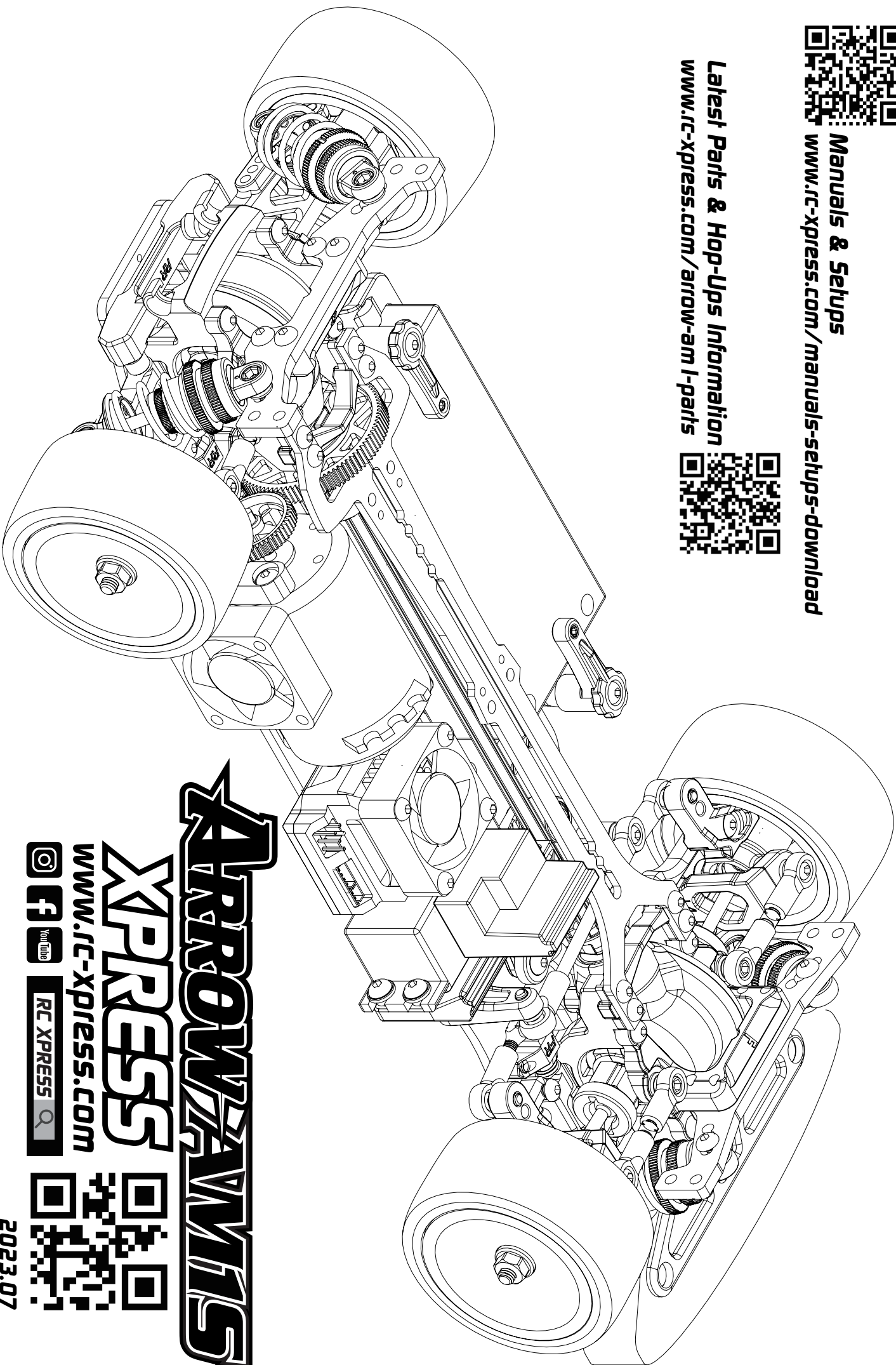

ARROW AM1S

XPRESS

www.rc-xpress.com



RC XPRESS



2023.07